

Rockingham Arts Centre

2027 Exhibition Application Information Pack



rockingham.wa.gov.au



2027 Exhibition Application Information Pack

Applications Open 25 May – 24 July 2026

The Rockingham Arts Centre (RAC) is currently seeking proposals for their 2027 exhibition period. Applications from individual artists, groups, curators, institutions, and Rockingham based arts groups are encouraged. An exhibition application is required from all applicants.

About the Rockingham Arts Centre

Located in a prime position at 11 Kent Street, Rockingham, the RAC is located in a refurbished ambulance centre. In 2022, the Centre underwent an extensive refurbishment to bring it in line with the needs of exhibiting artists. The gallery consists of a main exhibition space and an adjacent smaller project and workshop space. Successful applicants will exhibit in the main gallery with the project space available for workshops and other art related events. The project space also has the capacity to host smaller exhibitions.

How to apply

[Complete the online application form](#)

Detailed information about applying and exhibiting can be found below. If you have further questions, please contact:

James Walker, Community Development Officer (Art Programs and Collections)
artscentre@rockingham.wa.gov.au or 9527 0734

Key dates

- Applications open – Monday 25 May 2026
- Applications close – Friday 24 July 2026
- Applicants will be advised that their application has been received within five days of submission
- Panel assessments will commence the first week of August 2026
- Applicants will be advised of their proposal outcomes within six weeks of the closing date.

Proposal Advice

The selection panel are looking for proposals that extend the applicants professional practice and are reflective of contemporary issues and ideas. First Nations people and those from diverse cultural backgrounds are encouraged to apply. We are committed to ensuring that all artists have equal opportunities to access, engage and participate in the Centre's activities.

Practical tips for your application

- Write clearly without jargon – get your idea across as simply and clearly as possible.



2027 Exhibition Application Information Pack

- Use high quality images to support your application. These should include past, relevant work as well as images indicative of the work you plan to exhibit.
- Pay attention to the dimensions and capabilities of the exhibition space (refer to the main gallery floor plan attached here for reference).
- Provide an up to date, relevant CV for yourself or, if the application is on behalf of a group, a group biography, including aims and aspirations, purpose, and images from individual group participants.

Selection criteria

The selection panel will assess applications based on the following criteria:

- Conceptual – are the ideas under-pinning the work relevant and coherent.
- Technical – do the images demonstrate technical abilities within the chosen medium(s).
- Audience – would a wider audience be engaged through workshops, artists talks etc.
- Ingenious – is the project inventive and original.
- Suitability – have the opportunities and constraints of the RAC space and/or communities of Rockingham been considered.

Exhibition information

Exhibitions generally run for up to three weeks (three weekends).

Community group exhibitions generally run for one week, including one weekend.

Opening events for the curated exhibition program take place on the first Saturday following exhibition start date from 2-4pm, apart from *public holidays.

*Curated exhibitions will not be scheduled to commence on any week leading up to and requiring openings on Saturdays that fall on a long weekend. Community groups may be scheduled for these times.

Good Friday, Easter Saturday and Easter Sunday are considered public holidays as is Australia Day and ANZAC Day. The RAC will be closed to the public if any of these public holidays are within our normal operating hours.

In consultation with the curatorial team, curated exhibition installation generally commences from 12 noon on the Monday prior to the exhibition opening unless otherwise advised by the City in writing.

In consultation with the curatorial team, curated exhibition de-installation may take place after 4pm on the final Sunday of the exhibition period. De-installation is to be completed no later than 12pm on the Monday following the exhibition closure unless otherwise advised by the City in writing.



2027 Exhibition Application Information Pack

The City reserves the right to extend or shorten exhibitions depending on the application and calendar constraints.

Gallery Hours:

10am – 12.30pm and 1pm - 4pm, Wednesday to Sunday

Closed Public Holidays (please note: Easter Saturday and Easter Sunday are deemed Public Holidays)

Exhibition Space

See plan below (Please note: this plan is not to scale and ceiling mount locations are not an accurate representation of space or location)

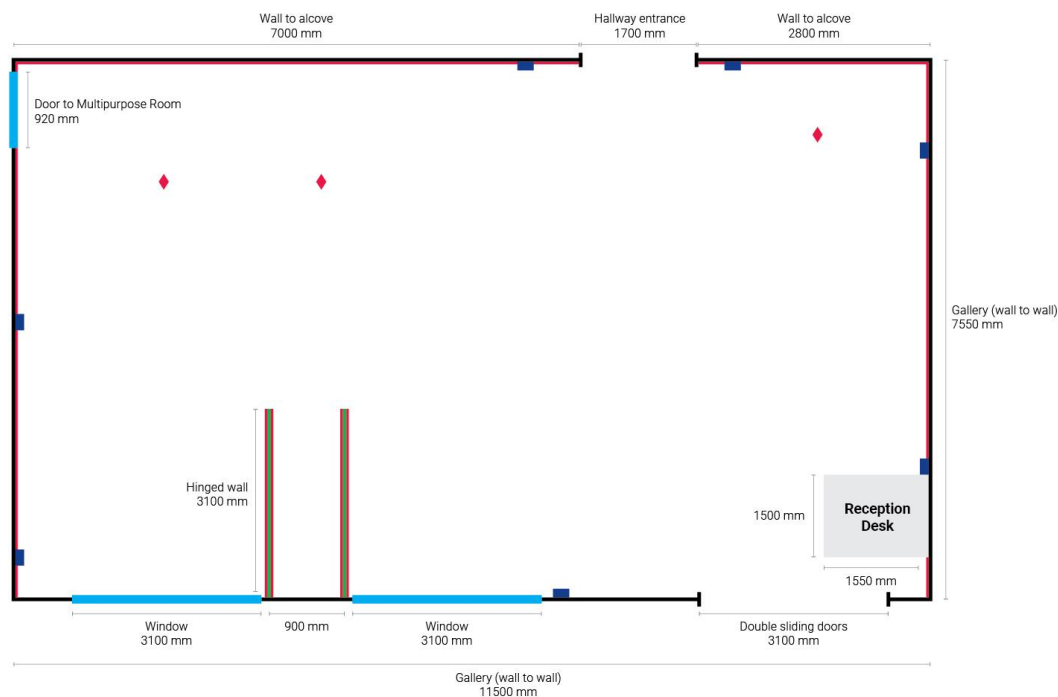

Legend

- Fixed wall – 10 mm thick plasterboard
- Hinged wall – 13 mm thick plasterboard
- Opening for door or window
- Double power point
- Artiteq Click Rail
- Ceiling mount hanging point

↑ Ceiling height
3200 mm

↑ Hinged wall height
3000 mm

↑ Artiteq Click Rail height
Wall – 3050 mm

↑ Artiteq Click Rail height
Hinged wall – 2850 mm

Approximate gallery floor area
86 m²

- The main gallery has two large swinging walls that can be positioned across the facades main windows to create more hanging space and to reduce light in the gallery, or they



rockingham.wa.gov.au



2027 Exhibition Application Information Pack

can be rotated to 90 degrees out from the wall to break up the internal space, allowing more natural light in.

- A gallery hanging system, inclusive of two (2) types of drops/wires and clutch hooks are available.
- There are three (3) anchoring panels located in the ceiling for suspended works to be displayed from. There are four (4) points in each location. Each of these points has a maximum weight limit of 20 kg per point with a total of 80 kg per location. Data projector may also be suspended from these anchor points.
- The space is fitted with gallery style track lighting. Please note that lighting adjustments will be done in consultation with the Curator and/or other gallery staff.
- Direct fixing to the walls is discouraged. Any direct fixing will require pre-approval from the City and will only be approved if the artist commits to filling and re-painting the walls on de-installation to its original state. Artwork must weigh under 2kg each.

Equipment:

- Plinths – there are fifteen (15) plinths of varying dimensions and materials.
- AV equipment – data projector – can be suspended from ceiling or mounted on custom plinths.

Inclusions:

- With the exception of exhibitions held by community groups, the Curator/s will assist artists to develop their exhibition plan and install their works.
- Artists are strongly encouraged to reach out to the Curator/s to discuss their exhibition plan and hanging options well in advance of the installation date.
- Assistance from an RAC Community Development Officer with advice on applying for an exhibition, planning, curation, hanging, labelling, lighting etc. is available for community art groups.

Installation and De-installation

- Installation will begin on a Monday generally at 12 noon unless otherwise advised by the City and will run for approximately 2 days.
- The RAC Curator/s are responsible for the final presentation and approval.
- De-installation can begin at 4 pm on Sunday and continue to 12 pm on Monday unless otherwise advised by the City.
- Assistance and support with installation will be provided on agreement with the Curator and will be treated on an as-needs basis.
- All works to be hung on walls must come with D-rings ready for installation. All other needs must be discussed and agreed upon with the Curator prior to installation.



2027 Exhibition Application Information Pack

- Artists must make good all walls and fittings immediately following de-installation, any costs incurred by the City to repair or make good the walls may be passed onto the artists.
- As storage is limited, the delivery of works should be discussed and agreed with the City prior to installation. Upon de-installation of the exhibition all artworks are required to be removed as works cannot be stored at the Centre post de-installation. The City will not be responsible for any damage incurred should any works remain onsite following de-installation times.

Gallery fees, costs, and inclusions

- Gallery hire fee \$100 (including GST) per week for community artists and community groups.
- While individual Public Liability Insurance is preferred, the City can assist with insurance for those without Public and Products Liability Insurance under certain circumstances.
- There is a commission of 20% plus GST on all sales from selected independent artists and collaborations. Sales of artworks will be managed by the RAC.
- Rockingham community-run exhibitions are required to roster their own staff to supervise the gallery for the duration of the exhibition and handle all artwork sales. A commission will not be taken in this instance.
- Based on the recommendations of the selection panel, the selected applications (excluding community artists and community groups) will be awarded a fee of up to \$1,000 per exhibition, regardless of the number of artists involved. They will not be required to pay the gallery hire fee.
- As a part of their fee, selected artists are required to provide an artist talk at a time to be negotiated with the Curator and RAC staff. Artists also have the option of presenting a community workshop as part of their exhibition in addition to the artist talk requirements. The workshop is a paid opportunity at NAVA rates and at the discretion of the City and Curator. Only one paid workshop opportunity per exhibition is available for each artist/artist group. Any additional paid workshops for group exhibitions etc. to be negotiated with RAC.
- If an artist or community group damages the main gallery space or equipment, any repair costs may be on-charged.

2027 Exhibition Application Information Pack

Rockingham Arts Centre Services	Selected Exhibiting Artist/s	Selected Community Artist/s	Selected Community Group
Artist Fee	Yes	N/A	N/A
Install/De-install service	Yes	Negotiation with City Staff	Negotiation with City Staff
Exhibition and installation information session	N/A	Yes	Yes
Catering for opening event (alcohol not provided) Specific dietary requirements may have limited options	Yes	No	No
Design and print double-sided DL flyer	Yes	No	No
Exhibition poster	Yes	No	No
Electronic invitation designed and distributed via email by the City	Yes	No	No
Advertising	Yes	City limited	City limited
Gallery Hire Fees	N/A	Required	Required
Commission Sales – 20% + GST	Required	N/A	N/A

2027 Exhibition Application Information Pack

Artist/Group Obligations	Selected Exhibiting Artist/s	Selected Community Artist/s	Selected Community Group
Artist Talk	Required	Optional	Optional
Workshop	Optional	Optional	Optional
Share social media/website links (if available)	Required	Required	Required
Share mailing lists and/or promote exhibition through own channels	Required	Required	Required
Staffing roster for exhibition	City responsibility	Required	Required
Process all exhibition sales and distribute funds	City responsibility	Required	Required