

Appendix 1 Certificate of Titles

WESTERN



AUSTRALIA

REGISTER NUMBER 986/DP202758	
DUPLICATE EDITION 4	DATE DUPLICATE ISSUED 12/12/2014

RECORD OF CERTIFICATE OF TITLE
UNDER THE TRANSFER OF LAND ACT 1893

VOLUME
2128

FOLIO
381

The person described in the first schedule is the registered proprietor of an estate in fee simple in the land described below subject to the reservations, conditions and depth limit contained in the original grant (if a grant issued) and to the limitations, interests, encumbrances and notifications shown in the second schedule.

REGISTRAR OF TITLES



LAND DESCRIPTION:

LOT 986 ON DEPOSITED PLAN 202758

REGISTERED PROPRIETOR:
(FIRST SCHEDULE)

ROCKINGHAM PARK PTY LTD OF 242 LEACH HIGHWAY, MYAREE
(T K254327) REGISTERED 2 JULY 2007

LIMITATIONS, INTERESTS, ENCUMBRANCES AND NOTIFICATIONS:
(SECOND SCHEDULE)

1. THE LAND THE SUBJECT OF THIS CERTIFICATE OF TITLE EXCLUDES ALL PORTIONS OF THE LOT DESCRIBED ABOVE EXCEPT THAT PORTION SHOWN IN THE SKETCH OF THE SUPERSEDED PAPER VERSION OF THIS TITLE.
2. M624158 EASEMENT TO WATER CORPORATION FOR PIPELINE PURPOSES. SEE DEPOSITED PLAN 401071 REGISTERED 1.5.2014.

Warning: A current search of the sketch of the land should be obtained where detail of position, dimensions or area of the lot is required.
* Any entries preceded by an asterisk may not appear on the current edition of the duplicate certificate of title.
Lot as described in the land description may be a lot or location.

-----END OF CERTIFICATE OF TITLE-----

STATEMENTS:

The statements set out below are not intended to be nor should they be relied on as substitutes for inspection of the land and the relevant documents or for local government, legal, surveying or other professional advice.

SKETCH OF LAND: 2128-381 (986/DP202758).
PREVIOUS TITLE: 1687-342.
PROPERTY STREET ADDRESS: 865 BALDIVIS RD, BALDIVIS.
LOCAL GOVERNMENT AREA: CITY OF ROCKINGHAM.

- NOTE 1: A000001A LAND PARCEL IDENTIFIER OF PEEL ESTATE LOT 986 (OR THE PART THEREOF) ON SUPERSEDED PAPER CERTIFICATE OF TITLE CHANGED TO LOT 986 ON DEPOSITED PLAN 202758 ON 28-SEP-02 TO ENABLE ISSUE OF A DIGITAL CERTIFICATE OF TITLE.
- NOTE 2: THE ABOVE NOTE MAY NOT BE SHOWN ON THE SUPERSEDED PAPER CERTIFICATE OF TITLE OR ON THE CURRENT EDITION OF DUPLICATE CERTIFICATE OF TITLE.

ORIGINAL—NOT TO BE REMOVED FROM DEPARTMENT OF LAND ADMINISTRATION

Application G734957

WESTERN



AUSTRALIA

REGISTER BOOK VOL. FOL.

Volume 1687 Folio 342

CT 2128 381
[Barcode]

CERTIFICATE OF TITLE

UNDER THE "TRANSFER OF LAND ACT, 1893" AS AMENDED

I certify that the person described in the First Schedule hereto is the registered proprietor of the undermentioned estate in the undermentioned land subject to the easements and encumbrances shown in the Second Schedule hereto.

Dated 11th March, 1998

John Gladstone
REGISTRAR OF TITLES

ESTATE AND LAND REFERRED TO

Estate in fee simple in portion of Peel Estate Lot 986, delineated on the map in the Third Schedule hereto, limited however to the natural surface and therefrom to a depth of 60.96 metres.

FIRST SCHEDULE (continued overleaf)

Malcolm Donald MacDonald of R.M.B. 258, Baldivis Road, Baldivis.

SECOND SCHEDULE (continued overleaf)

NIL

THIRD SCHEDULE

PERSONS ARE CAUTIONED AGAINST ALTERING OR ADDING TO THIS CERTIFICATE OR ANY NOTIFICATION HEREON

Superseded - Copy for Sketch Only

Page 1 (of 2 pages) 2128 381
VOL. FOL.

Scale 1:7500
ME

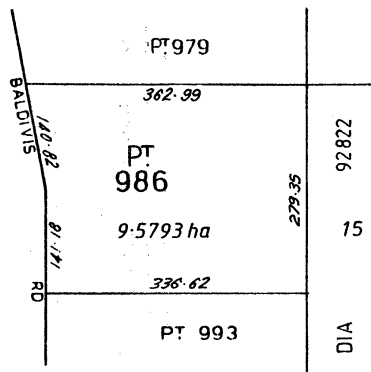

NOTE: ENTRIES MAY BE AFFECTED BY SUBSEQUENT ENDORSEMENTS.

WESTERN



AUSTRALIA

REGISTER NUMBER 993/DP202758	
DUPLICATE EDITION 3	DATE DUPLICATE ISSUED 12/12/2014

RECORD OF CERTIFICATE OF TITLE
UNDER THE TRANSFER OF LAND ACT 1893

VOLUME
2128

FOLIO
382

The person described in the first schedule is the registered proprietor of an estate in fee simple in the land described below subject to the reservations, conditions and depth limit contained in the original grant (if a grant issued) and to the limitations, interests, encumbrances and notifications shown in the second schedule.

REGISTRAR OF TITLES



LAND DESCRIPTION:

LOT 993 ON DEPOSITED PLAN 202758

REGISTERED PROPRIETOR:
(FIRST SCHEDULE)

ROCKINGHAM PARK PTY LTD OF 242 LEACH HIGHWAY, MYAREE
(T K254327) REGISTERED 2 JULY 2007

LIMITATIONS, INTERESTS, ENCUMBRANCES AND NOTIFICATIONS:
(SECOND SCHEDULE)

1. THE LAND THE SUBJECT OF THIS CERTIFICATE OF TITLE EXCLUDES ALL PORTIONS OF THE LOT DESCRIBED ABOVE EXCEPT THAT PORTION SHOWN IN THE SKETCH OF THE SUPERSEDED PAPER VERSION OF THIS TITLE.

Warning: A current search of the sketch of the land should be obtained where detail of position, dimensions or area of the lot is required.
* Any entries preceded by an asterisk may not appear on the current edition of the duplicate certificate of title.
Lot as described in the land description may be a lot or location.

-----END OF CERTIFICATE OF TITLE-----

STATEMENTS:

The statements set out below are not intended to be nor should they be relied on as substitutes for inspection of the land and the relevant documents or for local government, legal, surveying or other professional advice.

SKETCH OF LAND: 2128-382 (993/DP202758).
 PREVIOUS TITLE: 1687-343.
 PROPERTY STREET ADDRESS: NO STREET ADDRESS INFORMATION AVAILABLE.
 LOCAL GOVERNMENT AREA: CITY OF ROCKINGHAM.

- NOTE 1: A000001A LAND PARCEL IDENTIFIER OF PEEL ESTATE LOT 993 (OR THE PART THEREOF) ON SUPERSEDED PAPER CERTIFICATE OF TITLE CHANGED TO LOT 993 ON DEPOSITED PLAN 202758 ON 28-SEP-02 TO ENABLE ISSUE OF A DIGITAL CERTIFICATE OF TITLE.
- NOTE 2: THE ABOVE NOTE MAY NOT BE SHOWN ON THE SUPERSEDED PAPER CERTIFICATE OF TITLE OR ON THE CURRENT EDITION OF DUPLICATE CERTIFICATE OF TITLE.

ORIGINAL—NOT TO BE REMOVED FROM DEPARTMENT OF LAND ADMINISTRATION

Application G734957

WESTERN



AUSTRALIA

Volume 1687 Folio 343

REGISTER BOOK
VOL. FOL.

CT 2128 382



CERTIFICATE OF TITLE

UNDER THE "TRANSFER OF LAND ACT, 1893" AS AMENDED

I certify that the person described in the First Schedule hereto is the registered proprietor of the undermentioned estate in the undermentioned land subject to the easements and encumbrances shown in the Second Schedule hereto.

Dated 11th March, 1998

John Henderson
REGISTRAR OF TITLES



ESTATE AND LAND REFERRED TO

Estate in fee simple in portion of Peel Estate Lot 993, delineated on the map in the Third Schedule hereto, limited however to the natural surface and therefrom to a depth of 60.96 metres.

FIRST SCHEDULE (continued overleaf)

Malcolm Donald MacDonald of R.M.B. 258, Baldivis Road, Baldivis.

SECOND SCHEDULE (continued overleaf)

NIL

THIRD SCHEDULE

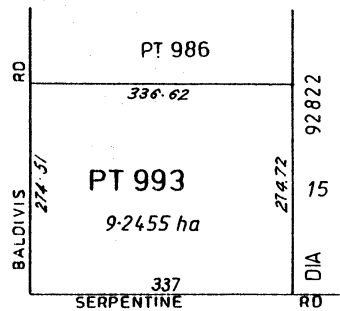

Scale 1: 7500

PERSONS ARE CAUTIONED AGAINST ALTERING OR ADDING TO THIS CERTIFICATE OR ANY NOTIFICATION HEREON

NOTE: ENTRIES MAY BE AFFECTED BY SUBSEQUENT ENDORSEMENTS.

Page 1 (of 2 pages)
2128
VOL.
382
FOL.

Superseded - Copy for Sketch Only

