

	Lots 335, 601 & 1001 (31.7658ha)	Yield	
	Application Area (26.5828ha)	Residential -	361 lots
	Balance of lot 601 (5.1824ha)	Educational -	1 lot
		Balance -	1 lot
		Total -	363 lots

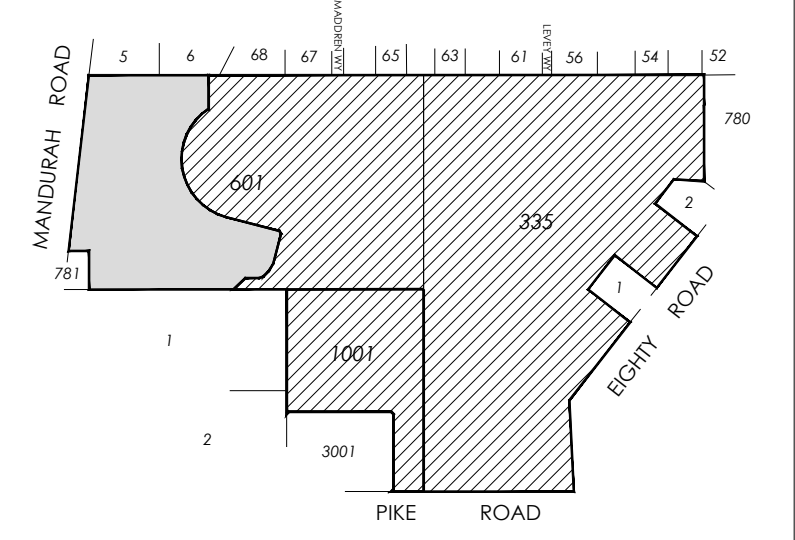

All road carriageway detail depicted on this Plan including pavements, road treatments, medians and parking are for illustrative purposes only and are subject to final engineering design and any relevant approvals. The detail reflects the intent of the road network standards preferred for this subdivision.
 All dimensions and areas depicted on this Plan are subject to pre-cal and final survey and will vary from the figures shown.



PROPOSED SUBDIVISION
 Lot 335, 601 & 1001 Pike Road, Baldvis
 City of Rockingham



plan no: 2300-104-01
 scale: 1:2500@A3, 1:1250@A1
 date: 31.07.2014

T: (+618) 9382 1233 F: (+618) 9382 1127
 E: admin@cleplan.com.au
 www.cleplan.com.au
 L2-36 ROWLAND STREET SUBIACO WA 6008
 PO BOX 796 SUBIACO WA 6904

This plan is current at the revised date & subject to approval, survey & engineering detail. This plan remains the property of CLE ©