

COOMBS

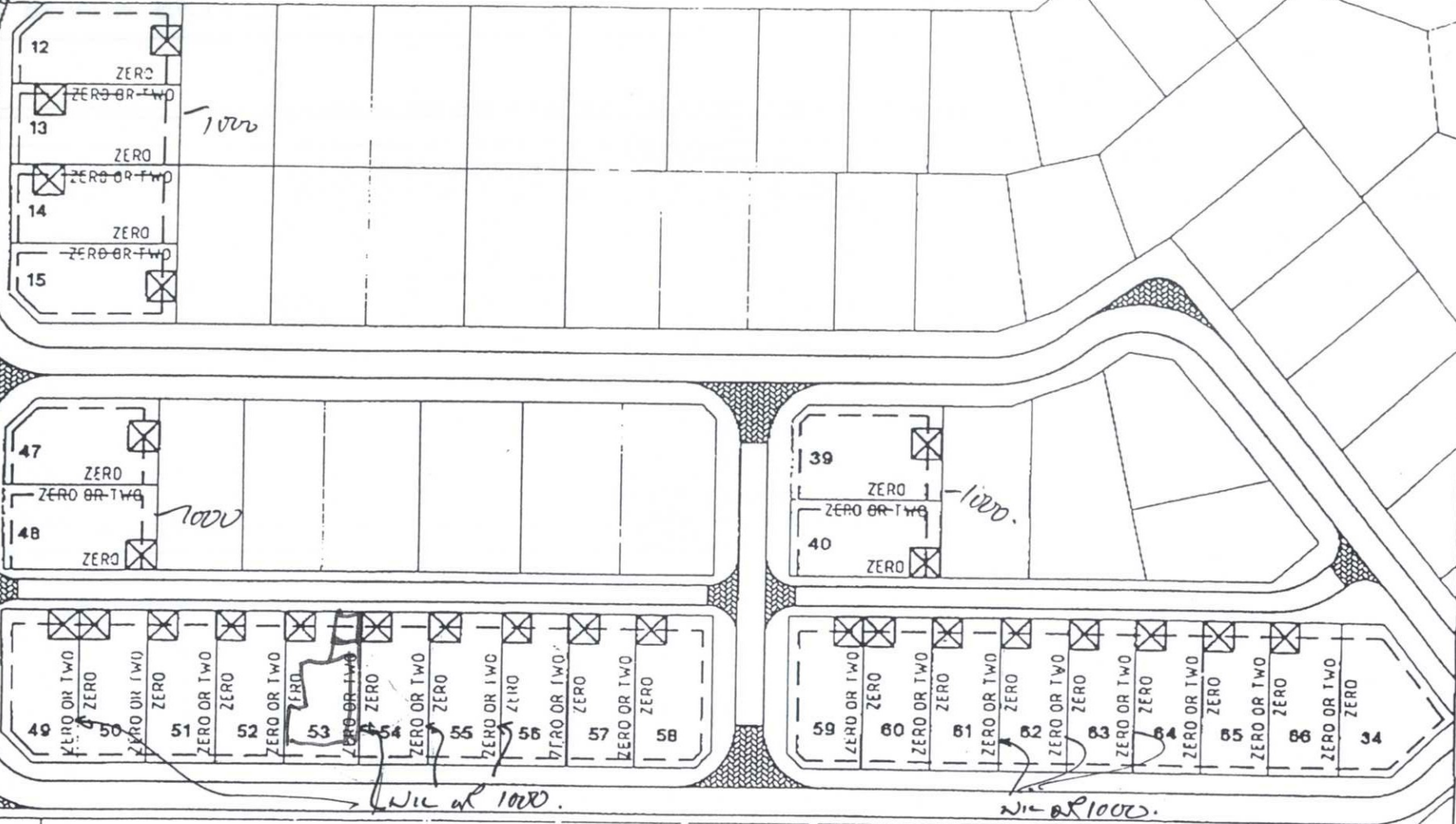

NOTE:
 1. LOT LAYOUT IS INDICATIVE ONLY.
 2. LOCATION OF CAR ACCOMMODATION IS INDICATIVE ONLY.

SETBACK BOUNDARY

PROJECT: **PALM BEACH ESTATE**
 DRAWING TITLE: **PARKSIDE PRECINCT LOTS - SETBACKS & ZERO SETBACKS**
 PROVIDED BY: **LESTER PALM BEACH ESTATE PTY LTD**

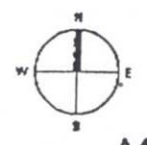

CONSULTING ENGINEERS
 TOWN PLANNERS
 PROJECT MANAGERS
 ENVIRONMENTAL CONSULTANTS

1000 Centre Street, Suite 100
 P.O. Box 200, Southport
 Queensland 4215
 Telephone: (07) 5531 3000
 Facsimile: (07) 5531 3001

DATE: 10/10/11
 DRAWN BY: [Signature]
 CHECKED BY: [Signature]
 APPROVED BY: [Signature]
 PROJECT NUMBER: P98041-003
 DRAWING NUMBER: P548-SK2

23821.