

The Town Planning Scheme and The Residential Design Codes are varied in the following manner:

1. All dwellings and ancillary development must be located within the building envelopes as depicted on the DAP.
2. The requirements of the Residential Design Codes are varied as shown on the DAP
3. The requirements of the Residential Design Codes and Town Planning Scheme shall be satisfied in all other matters.
4. Consultation with adjoining or other landowners to achieve a variation to the Residential Design Codes, as provided for by the DAP, is not required.
5. Density Coding is as depicted on the Detailed Area Plan.
6. An alternative garage location to that shown on the plan may be approved by the Manager, Statutory Planning subject to the design meeting solar orientation principles, streetscape objectives and statutory requirements.
7. A ten percent (10%) variation to minimum open space requirements (in addition to that described in the Open Space definition of the Codes) shall be permitted for single storey dwellings. Open space shall be calculated in accordance with the provisions of the 2002 Residential Design Codes.
8. A nil setback is permissible on the lots where shown on the DAP (generally the southern eastern or eastern boundaries). Side setbacks for lots coded R30 or higher may be reduced to nil for 2/3 the length of the boundary provided that walls do not exceed 3m average and 3.5m maximum height.
9. A 2m solar setback applies, as shown on the DAP, generally along the boundary which adjoins a permitted nil setback boundary (on an abutting lot). Council will only consider applications for structural development in the solar setback where the principles and benefits of solar access to the dwelling are being maintained.
10. The front setback of all dwellings shall be determined in accordance with the following:
 - i) The minimum primary street setback shall be 1.5m
 - ii) The maximum setback of a wall addressing the primary street shall be 3.5m
11. It is mandatory for all allotments with laneway access to locate carports and garages at the rear with access via the laneway.
12. Fences shall not be located within 0.5m of the intersection of a crossover and shall be truncated at 45 degrees so that no portion of the fence is within the truncation in order to enhance safety and sight lines.
13. Rear garage setbacks minimum shall be 1.0m with no protrusion of both eaves and gutters into setback.
14. All dwellings to address the primary street.

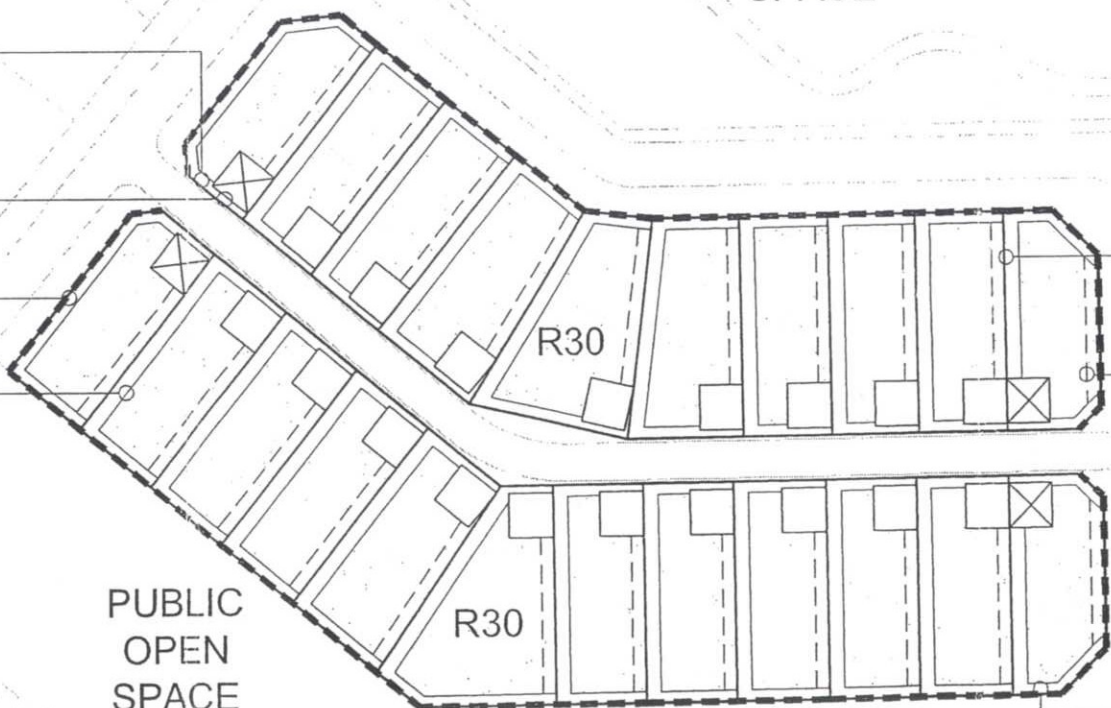

BELGRAVIA TERRACE



1.5m MINIMUM REAR SETBACK

1m MINIMUM REAR SETBACK TO GARAGE

1.5m MINIMUM SIDE SETBACK

2m MINIMUM SOLAR SETBACK

ZERO SETBACK TO SOUTHERN BOUNDARY AS PER CLAUSE 3.3.2 A2 iii OF THE 2002 R-CODES

1.8m MINIMUM SECOND STOREY SETBACK

1.5m MINIMUM FRONT SETBACK MAXIMUM OF 3.5m

This Detailed Area Plan as shown has been adopted by Council and signed by the Principal Planner.

Principal Planner: *[Signature]* Date: 19.5.04

DETAILED AREA PLAN
STAGES 11 AND 12 - ANCHORAGE
CITY OF ROCKINGHAM

- LEGEND**
- BUILDING ENVELOPES
 - PREFERRED GARAGE LOCATION
 - DESIGNATED GARAGE LOCATION
 - SECOND STOREY SETBACK
 - 0.1m NO ACCESS STRIP



Client: AUSTRALAND		Scale: 1:1000 at A3	
Drawn: ES		Checked: JB	
Approved: DC		Date: 23/02/04	
XREFS:			
A	PRELIMINARY	23/02/04	ES
No.	Revision	Date	Initial
Size: A3		Dwg. No. AST ROC DAP 07	
		Rev: A	

roberts day 43602
town planning + design

Perth
Level 1, 130 Royal Street, East Perth WA 6004
GPO Box 6369 East Perth WA 6892
T: 61 8 9218 8700
F: 61 8 9218 8701

Melbourne
Suite 2, 33 Chessel St. SOUTH MELBOURNE VIC 3205
T: 61 3 9645 0788
F: 61 3 9645 0799

Sydney
King Street Wharf, Suite 412, Lime St. SYDNEY NSW 2000
T: 61 2 8270 8300
F: 61 2 8270 8399
www.robertsday.com.au