

**1 Pedestrian Ramp**

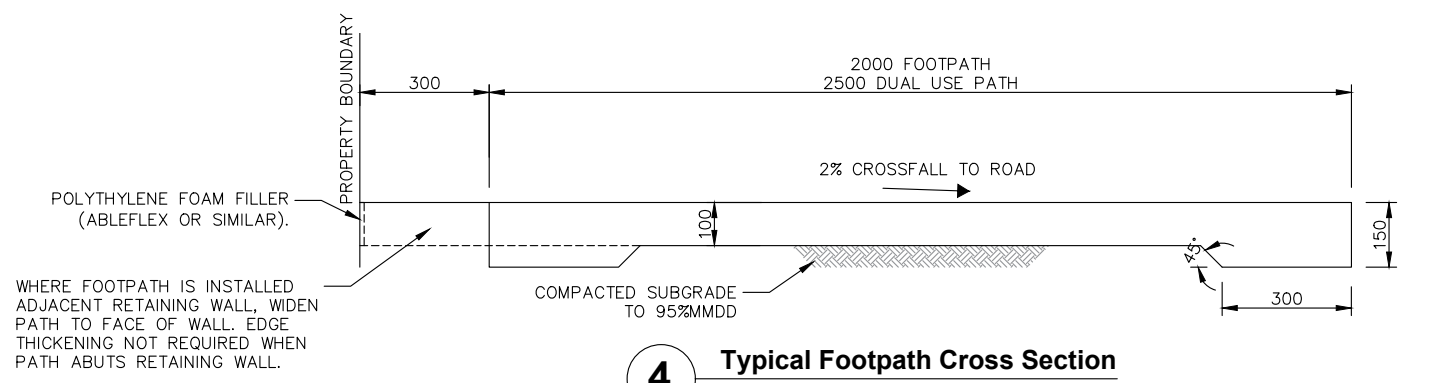

**4 Typical Footpath Cross Section**

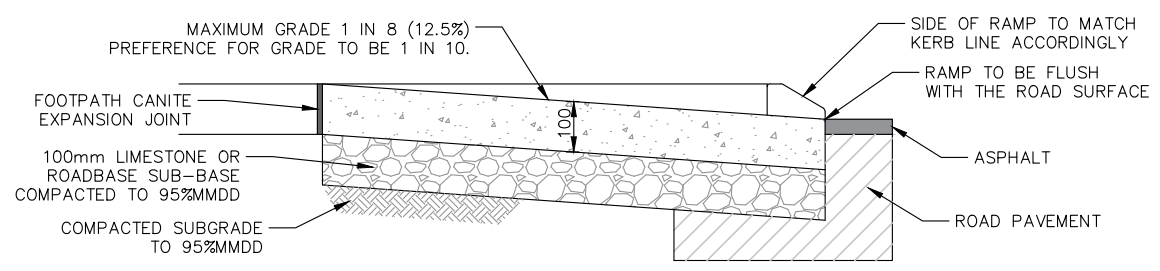

**Section A-A**

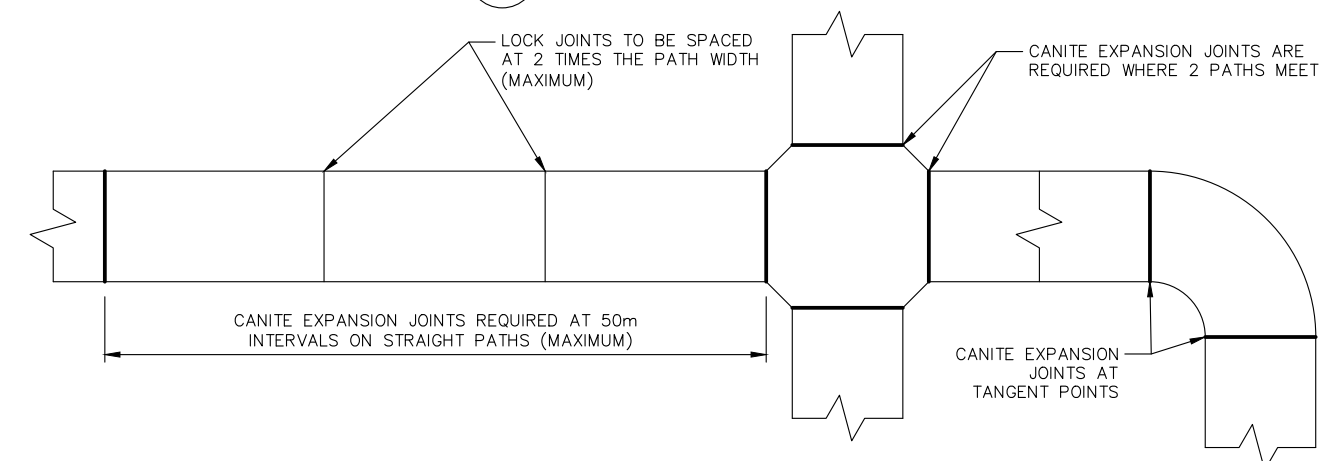

**5 Typical Footpath Plan**

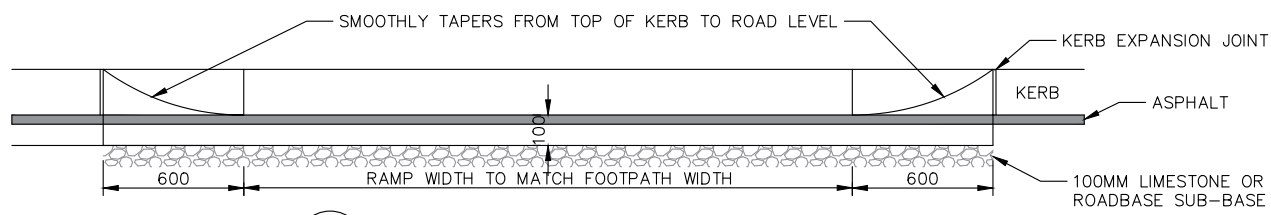

**2 Front Elevation - Pedestrian Ramp**

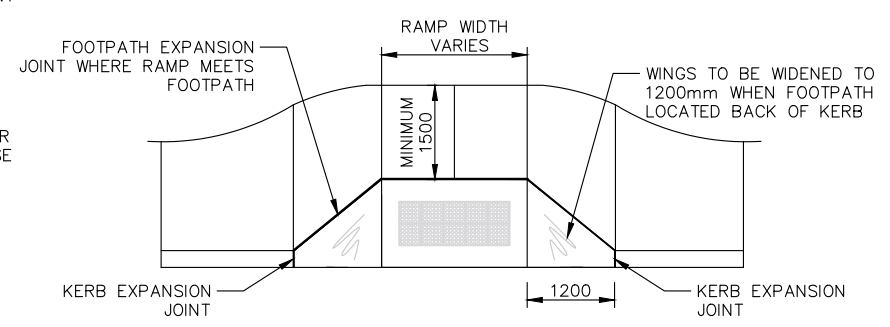

**6 Back of Kerb Path and Pram Ramp Detail**

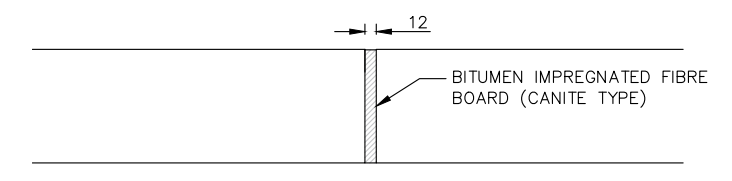

**7 Footpath Expansion Joint Detail**

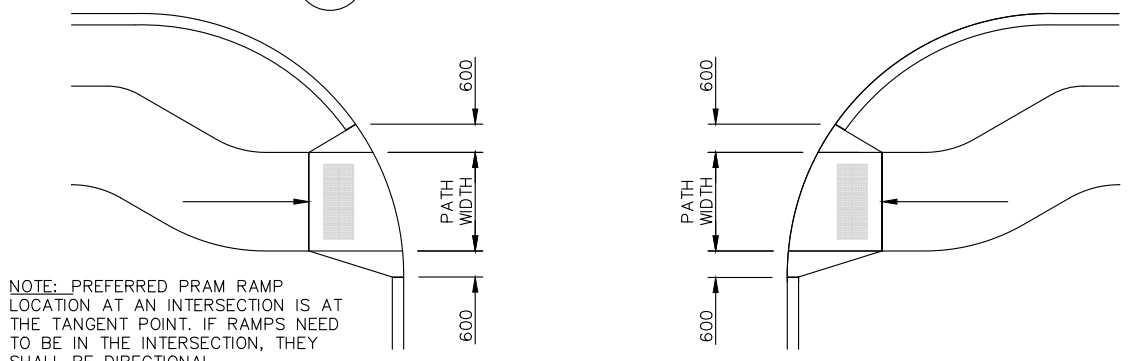

**3 Directional Pram Ramp**

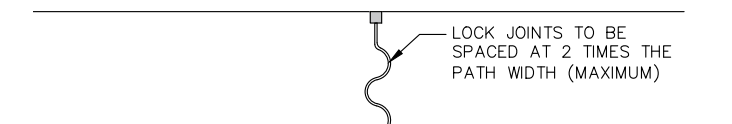

**8 Footpath Contraction Joint Detail**

**FOOTPATH NOTES:**

1. ALL CONCRETE FOR FOOTPATH CONSTRUCTION TO BE IN ACCORDANCE WITH AS 1379 & AS 3600 AND MINIMUM COMPRESSIVE STRENGTH OF 25 MPA AT 28 DAYS, 20MM AGGREGATE AND A MAXIMUM SLUMP OF 75MM AT DELIVERY.
2. SUB-GRADE SHALL BE FREE OF DELETERIOUS MATERIAL SUCH AS TREE ROOTS, ROCKS ETC. FOR A DEPTH OF 150MM BELOW THE PATH, SUB-GRADE SHALL BE UNIFORMLY WATERED AND COMPACTED TO ACHIEVE 95% MMDD.
3. ALL EXPOSED FACES OF THE COMPLETED FOOTPATH SHALL BE KEPT PERMANENTLY WET FOR THE CURING PERIOD OF A MINIMUM 72 HOURS AFTER PLACING. ALTERNATIVELY CONCRETE MAY BE CURED BY SPRAYING WITH A MEMBRANE CURING COMPOUND.
4. ALL CONCRETE SHALL BE BROOM FINISHED TO PROVIDE A NON-SLIP SURFACE IN ACCORDANCE WITH AS 4586, WITH SMOOTH EDGE APPROXIMATELY 75MM WIDE (BULL-NOSE TROWEL) AT EDGES AND JOINTS.
5. FOOTPATH GRADIENTS ARE TO BE IN ACCORDANCE WITH AS 1428.1 WHERE A PEDESTRIAN INCLUSIVE DESIGN IS REQUIRED.
6. MAXIMUM CROSSFALL PERMITTED OF 2.5% (1 IN 40) IN ACCORDANCE WITH AS 1428.1. 2% PREFERRED TO ALIGN WITH VERGE GRADE.
7. MINIMUM VERTICAL CLEARANCE ALONG FOOTPATHS TO BE 2.5m.
8. WHERE FOOTPATHS ARE CONSTRUCTED ADJACENT TO THE KERB, FOOTPATH AND KERB CONTRACTION AND EXPANSION JOINTS ARE TO ALIGN.
9. ALL LOCK JOINTS MUST BE CONSTRUCTED IN ACCORDANCE WITH LOCK JOINT AUSTRALIA STANDARDS.

**PRAM RAMP NOTES:**

1. TACTILE PAVERS TO BE USED ALONG BUS ROUTES, AROUND SCHOOLS, HOSPITALS AND COMMUNITY CENTRES IN ACCORDANCE WITH AS 1428.4.1 - DESIGN FOR ACCESS AND MOBILITY.
2. PRAM RAMPS TO BE EXTRUDED USING 32MPA GRADE CONCRETE IN ACCORDANCE WITH AS 1379 WITH FIBRE REINFORCEMENT AT A MIXING RATE OF 0.9KG/M3. MAXIMUM AGGREGATE SIZE OF 10MM WITH MAXIMUM SLUMP AT DELIVERY OF 90MM.
3. SUBBASE SHALL BE UNIFORMLY WATERED AND COMPACTED TO ACHIEVE 95% MMDD
4. PRAM RAMPS WINGS TO BE WIDENED TO 1200mm WHEN FOOTPATH IS LOCATED BACK OF KERB IN ACCORDANCE WITH AS 1428.1
5. ALL CONCRETE SHALL BE BROOM FINISHED PERPENDICULAR TO THE DIRECTION OF PEDESTRIAN TRAFFIC TO PROVIDE A NON SLIP SURFACE IN ACCORDANCE WITH AS 4586.



PO Box 2142  
Rockingham DC,  
WA 6169  
Telephone: (08) 9528 0333  
Fax (08) 9592 1705

NOT FOR CONSTRUCTION / INDICATIVE ONLY		
DRAWN	M CRUTCHETT	
CHECKED	P JACOBS	
APPROVED	J HENSON	05/2020
(MANAGER LAND & DEVELOPMENT INFRASTRUCTURE)		
FILE NAME	DRAWING NUMBER	REVISION
	002	A