

NOTES:

- DATUM FOR ALL LEVELS IS AHD.
- PIPE SIZES IN MILLIMETRES, DISTANCES AND LEVELS IN METRES.
- ALL LEVELS SHALL BE LOCATED FROM BENCH MARKS ESTABLISHED BY A LICENSED SURVEYOR.
- ALL DRAINAGE PIPES TO BE CLASS 2 RCP UNLESS NOTED OTHERWISE.
- MINIMUM COVER TO ANY PIPE TO BE 0.6m. CLEARANCES TO OTHER SERVICES TO BE 0.15m MINIMUM.
- CONTRACTOR TO LIAISE WITH RELEVANT AUTHORITIES WHEN NEAR EXISTING SERVICES.
- LOCAL AUTHORITY IS THE CITY OF ROCKINGHAM AND ALL CONSTRUCTION SHALL BE IN ACCORDANCE WITH THEIR CRITERIA.
- ALL DEBRIS AND RUBBISH MATERIAL SHALL BE REMOVED FROM SITE PRIOR TO COMPLETION OF THE WORKS AT THE CONTRACTORS EXPENSE.
- THIS DRAWING SHALL BE READ IN CONJUNCTION WITH THE CONTRACT DRAWINGS AND SPECIFICATION.
- UNLESS INSTRUCTED OTHERWISE THE CONTRACTOR SHALL NOT DISTURB ANY EXISTING TREES OR VEGETATION.
- KERB TYPE NOTED ON PLAN. REFER LEGEND.
- REFER PLAN '2356-VL-330' FOR SIGNAGE AND LINEMARKING PLAN.

CONCRETE NOTES:

- SUBGRADE FOUNDATION TO BE COMPACTED TO 95% MDD WHEN MEASURED IN ACCORDANCE WITH AS1289.
- REINFORCED CONCRETE SHALL BE 40 MPa COMPRESSIVE STRENGTH AT 28 DAYS, 75mm SLUMP AND A MAXIMUM AGGREGATE SIZE OF 20mm. UN-REINFORCED CONCRETE SHALL BE 32 MPa COMPRESSIVE STRENGTH.
- 12mm CANITE EXPANSION JOINTS ARE TO BE USED ON CURED FACES AND SEALED WITH BUTYL MASTIC COMPOUND FILLER OR EQUIVALENT.
- ALL CONCRETE SURFACES TO BE BROOM FINISHED 2mm DEEP TO PROVIDE A NON-SLIP SURFACE PARALLEL TO THE LINE OF THE KERB.
- AT SLAB JOINTS, EXPOSED FACES MUST NOT BE DE-BONDED AND THE FULL FACE OF EXPOSED JOINTS MUST BE SEALED TO PREVENT THE INGRESS OF MORTAR AND OTHER INCOMPRESSIBLE MATERIALS.
- EDGE THICKENING TO BE APPLIED TO ALL FREE EDGES, INTERFACES AND CHANGES IN PAVEMENT TYPES.
- ALL CONCRETE EDGES TO BE GIVEN A PICTURE FRAME FINISH USING A BULL-NOSE TROWEL.
- ALL WORKS TO BE DONE IN ACCORDANCE WITH THE CITY OF ROCKINGHAM'S SPECIFICATIONS.

LEGEND:

- PROPOSED KERB
- EXISTING KERB
- PROPOSED PAVEMENT MARKING
- PROPOSED BOLLARD (1.5m SPACING)
- PROPOSED SIGN
- EXISTING 'W' BEAM TRAFFIC BARRIER
- EXISTING BOLLARDS
- KERB TRANSITION OVER 2m
- MOUNTABLE KERB (FOR BRICK PAVING)
- SEMI-MOUNTABLE KERB (FOR BRICK PAVING)
- BARRIER KERB (FOR BRICK PAVING)
- REINFORCED FLUSH KERB
- REINFORCED RAISED KERB
- SAWCUT, EXPANSION & ISOLATION JOINTS IN CONCRETE PAVEMENT
- PROPOSED CONCRETE PAVEMENT
- PROPOSED TRAFFICABLE PAVING
- EXISTING CONCRETE PAVEMENT
- EXISTING PAVING
- DRAINAGE
- SEWER
- WATER MAIN
- SEWER PRESSURE MAIN
- GAS
- OPTIC FIBRE
- COMMUNICATIONS
- UNDERGROUND HIGH VOLTAGE POWER
- UNDERGROUND LOW VOLTAGE POWER
- IRRIGATION

LOADING ZONE EDGE THICKENING DETAIL

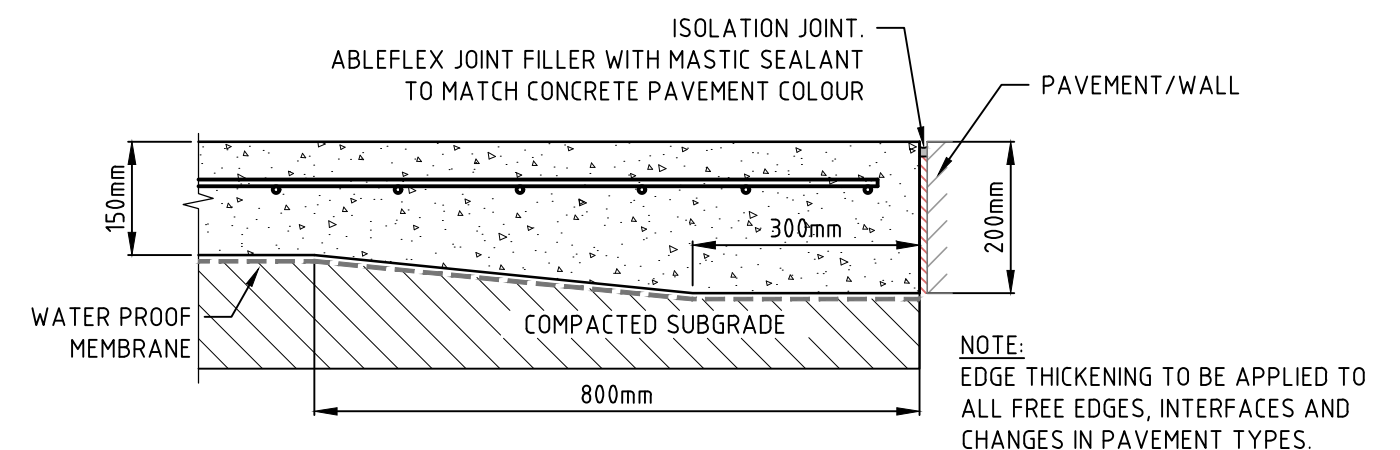

TRAFFICABLE PAVING - HAUNCHING DETAIL

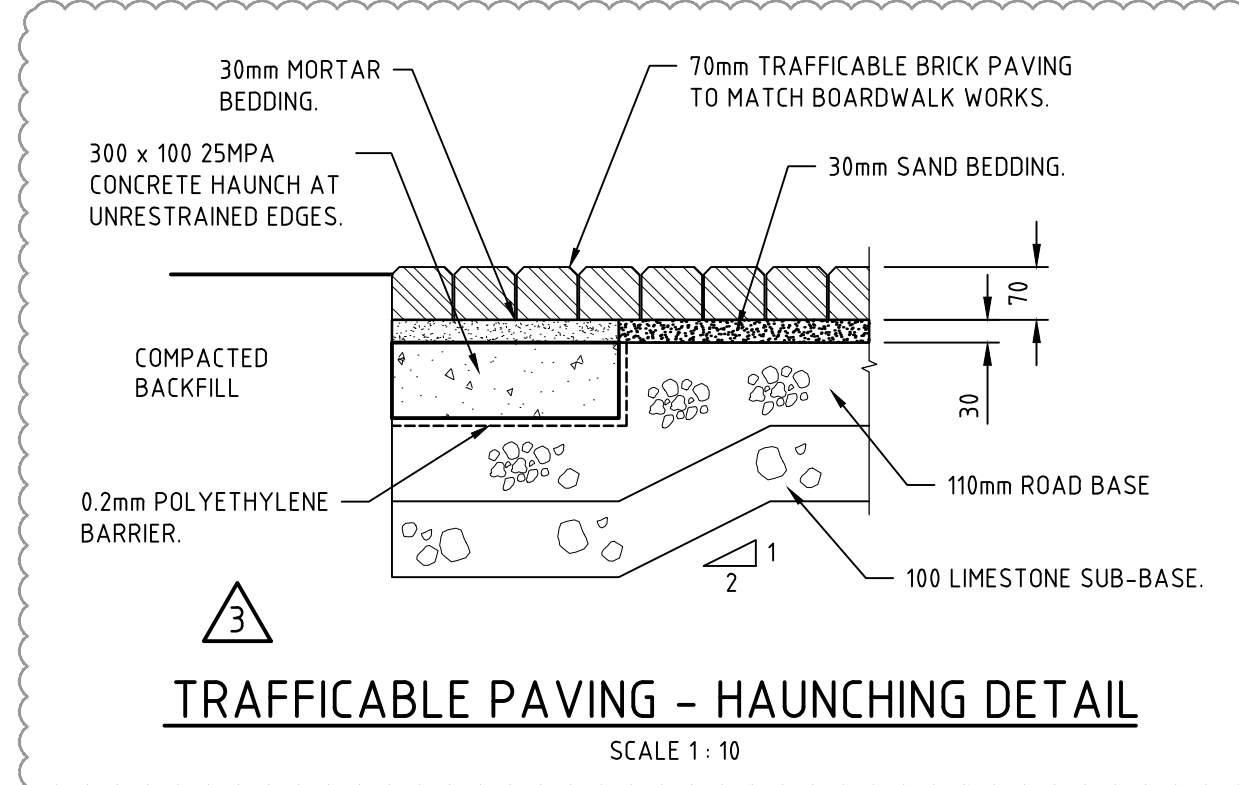

SAWCUT JOINT DETAIL (SC)

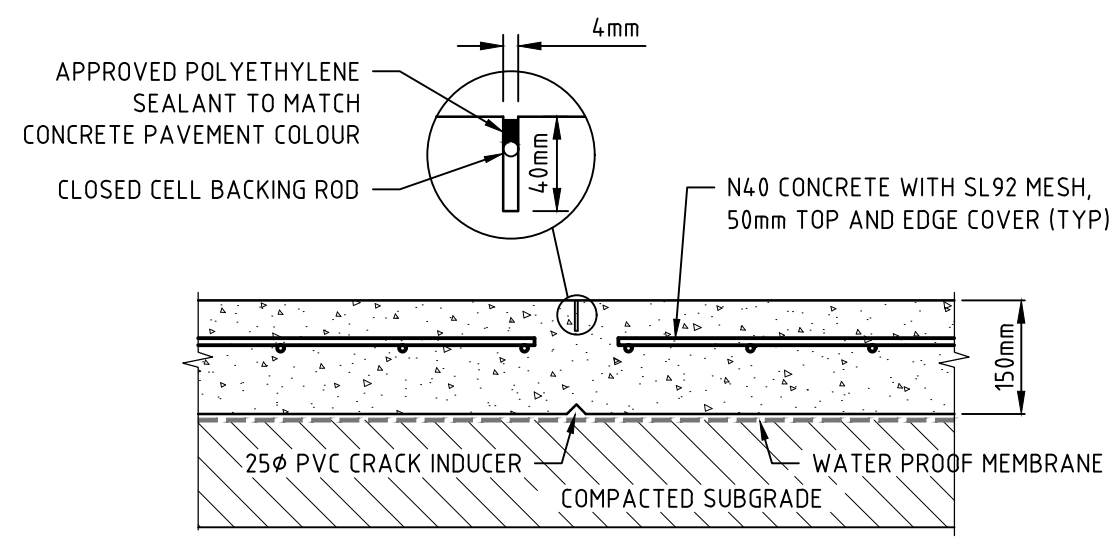

EXPANSION JOINT DETAIL (EJ)

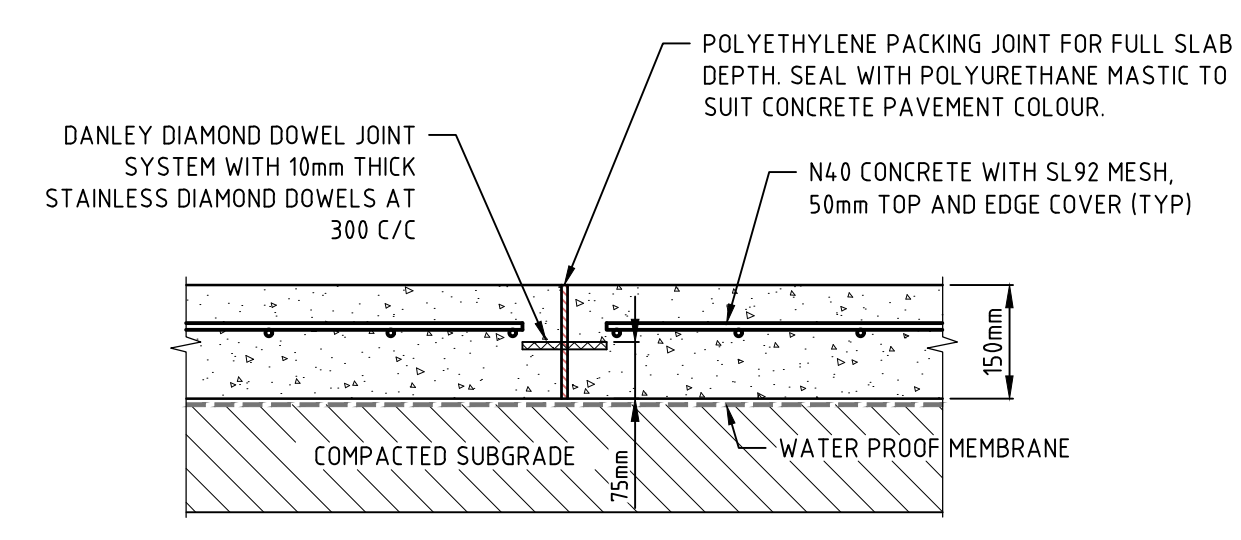

TRAFFICABLE 150mm CONCRETE PAVEMENT

No.	DATE	DRAWN	APPROVED	AMENDMENT
E	29.01.19	KS	MA	DETAILS AMENDED
D	23.01.19	KS	MA	SUBGRADE NOTES AMENDED
C	11.01.19	PK	MA	CoR COMMENTS INCLUDED / PATH DETAILS AND GRAB RAILS ADDED
B	29.06.18	DWP	BMS	CoR COMMENTS INCORPORATED.
A	22.06.18	DWP	BMS	ISSUED FOR INFORMATION.
No.	DATE	DRAWN	APPROVED	AMENDMENT

This plan shall not to be used for construction unless issued as rev O and signed as approved.

COPYRIGHT
The concepts and information contained in this document are the Copyright of TABEC Pty. Ltd. Use or copying of the document in whole or part without the written permission of TABEC Pty. Ltd. constitutes an infringement of copyright.

CLIENT	City of Rockingham
DESIGNED	DWP
CHECKED	BMS
APPROVED	B.M. SMITH
DATE	11.02.2019
DRAWN	DWP
CHECKED	BMS

TABEC PTY LTD
ACN 090 796 204

14 Wickham Street, East Perth WA 6004
T 08 9425 5900 E info@tabec.com.au
www.tabec.com.au

THIS DRAWING IS NOT TO BE USED FOR CONSTRUCTION UNLESS IT HAS BEEN CERTIFIED BY A PRACTISING STRUCTURAL ENGINEER.

PAUL TERPKOS
STRUCTURAL ENGINEER

Terpkos Engineering PTY LTD
COMPANY

04.02.2019
DATE

PROJECT	Rockingham Beach Foreshore Revitalisation
TITLE	VAL STREET / ESPLANADE CARPARK ROADWORKS PLAN
DRAWING NUMBER	2356-VL-300
ISSUE	3b

SCALE
0m 5m 10m
1:250

J:\2356\Design\CAD\Drawings\Val Street Carpark\2356-VL-300.dwg 01/08/19 1:58:04 plemm