

HERITAGE IMPACT STATEMENT FOUNDERS' MEMORIAL, ROCKINGHAM

**INTERSECTION RAILWAY TERRACE & PARKIN
& KENT STREETS ROCKINGHAM**



**PREPARED FOR
THE CITY OF ROCKINGHAM**

JUNE 2018

1.0	Introduction	3
2.0	Acknowledgements	4
3.0	Consultant Qualifications and Experience	5
4.0	Location Plans	6
5.0	Heritage Listings	8
6.0	Historical Development	10
7.0	Analysis of Documentary Evidence.....	21
8.0	Description of the Place	23
9.0	Significance	24
10.0	Proposal	24
11.0	Statement of Heritage Impact.....	27
12.0	Conclusion.....	34
13.0	Recommendations.....	35

1.0 Introduction

This Heritage Impact Statement (HIS) for The Founders' Memorial, Rockingham has been prepared for the owner, the City of Rockingham. This HIS forms part of the City's consideration for the implementation of the proposed Foreshore Masterplan. The project involves the upgrade of Railway Terrace, Beach Plaza and Boardwalk, Rockingham. The Founders' Memorial is located at the intersection of Railway Terrace, Parkin and Kent Street's, Rockingham, within the project area.

As part of the Masterplan the City has requested heritage advice on the possible relocation of the Founders' Memorial and possible changes to some of the finishes to the structure for aesthetic reasons.

Good conservation practice recommends the preparation of a HIS when any major development is proposed to a heritage place or a building within a heritage precinct to ensure that cultural heritage values are considered and respected.

Founders' Memorial is included in the City of Rockingham's Municipal Heritage Inventory with a 'B' Management Category. This category refers to a place worthy of a high level of protection. A site meeting was held on 17 November 2016 with City of Rockingham Officers, Michael Ross, Michael Wilson, Lee Battersby and with Heritage Advisor Stephen Carrick to discuss the proposal and the brief for this HIS.

The following scope of work was undertaken for this HIS:

- Provide a context for the historical development of the area using readily available historical information;
- Site inspection of the existing structure. Record the place through photographs;
- Liaise with the Rockingham District Historical Society;
- Review the documentary and physical evidence to understand the cultural heritage values of the place;
- Assess the impact of the proposed Masterplan, possible relocation and changes to the finishes, considering the cultural heritage values; and
- Document the above through the preparation of a heritage impact statement and recommendations.

The following information has been provided or accessed for the preparation of this HIS:

- Municipal Heritage Inventory Place Record Form for Founders' Memorial Rockingham – Place Number 54.
- Shire of Rockingham Council Minutes – Provided by the Rockingham District Historical Society.
- City of Rockingham Valuation & Condition Reports – Public Art Valuation 2015 for Founders' Memorial Clock.
- InHerit – Heritage Council of Western Australia's Database.
- Railway Terrace, Beach Plaza and Boardwalk – Existing Site Plan.
- Railway Terrace, Beach Plaza and Boardwalk – Proposed Site Plan Drawing.
- Information from Rob Forlani- Contemporary Artist and a student from the Rockingham Senior High School involved in the design and production of the Founders' Memorial.
- Correspondence with Gordon Hudson- Fine Art Conservator.

No additional historical research has been undertaken in determining the cultural heritage values of the place. It is noted that there is no Conservation Plan for the place.

A Building Permit search was undertaken by the City of Rockingham; however, no plans were able to be located.

Photographs taken are included as an appendix to this assessment. (Appendix A).

This Heritage Impact Statement has been prepared in accordance with the principles, processes and practice as outlined in the ICOMOS Burra Charter. Definitions of terms are in accordance with the Burra Charter.

2.0 Acknowledgements

The consultant would like to acknowledge the assistance of the following in the preparation of this Heritage Impact Statement:

- Michael Ross- Manager Statutory Planning, City of Rockingham.
- Michael Wilson- Senior Projects Officer, City of Rockingham.
- Lee Battersby- City of Rockingham.
- Wendy Durant - Rockingham District Historical Society.
- Rob Forlani- Contemporary Artist and ex Rockingham Senior High School Student involved in the design and production of the Founders' Memorial.
- Gordon Hudson- Fine Art Conservator.

3.0 Consultant Qualifications and Experience

Stephen Carrick is a registered architect and member of the Australian Institute of Architects with extensive experience and expertise having worked in private practice in Sydney from 1985 to 1992, for the Western Australian Government from 1992 to 2009 and from 2009 in private practice specialising in all aspects of heritage conservation work. He is a former Acting Director of the Heritage Council of WA and was responsible for managing the Development Referrals Program, Assessment and Registration Program, Grant Funding and the Heritage Advisory Program within the Heritage Council. He has previously been responsible for conservation programs for sites such as the World Heritage listed Fremantle Prison. He is experienced in preparing and assessing Heritage Impact Statements.

Stephen is on the University of Western Australia's Consultant Panel for Heritage Advisory Services and Building Conservation and WALGA's Panel of Heritage Advisory Services. He is the Heritage Advisor to the Shire's of Derby/West Kimberley, Toodyay, Quairading, Cunderdin, Tammin, Jerramungup and Gnowangerup and the City of Rockingham and City of Kalgoorlie-Boulder. He has been appointed to the Metropolitan Redevelopment Authority's Consultant Panel for Heritage Management Services and the City of Vincent's Design Advisory Committee.

Stephen has 30 years experience in the conservation and management of heritage sites. His experience and expertise have been developed from extensive work on large and small heritage projects in both metropolitan and regional Western Australia.

4.0 Location Plans

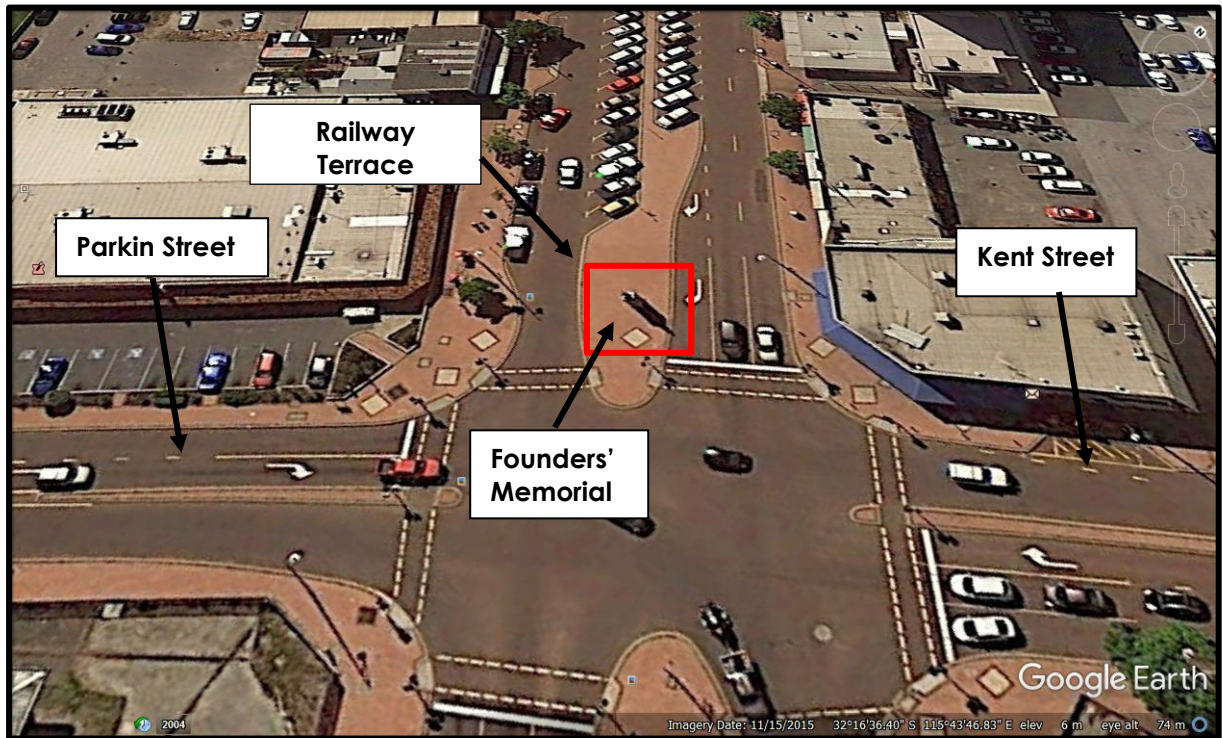

Locality Plan

Source: Google Earth 2017

RAILWAY TERRACE, BEACH PLAZA & BOARDWALK
EXISTING SITE PLAN



Site Plan – Existing
Source – City of Rockingham

5.0 Heritage Listings

State Register of Heritage Places

Statutory List:

The Founders' Memorial is not included on the Heritage Council of Western Australia's State Register of Heritage Places.

Non- Statutory:

The Heritage Council of Western Australia maintains a heritage database, 'InHerit'. The database contains information on statutory and non-statutory heritage listings, and the results of heritage surveys and studies.

The Founders Memorial is included in the State Heritage Office's 'Inherit' website database as a non-statutory heritage listing and is listed as place No. 18489. The 'Inherit' database refers to the place as being on the City of Rockingham's MHI that was adopted 25 March 2008.

There are no other listings that are referenced on the 'InHerit' database.

City of Rockingham Municipal Heritage Inventory

A Municipal Heritage Inventory is a survey of heritage places in the City of Rockingham. Inclusion in the Inventory alone does not mean that a property is 'heritage listed'. Heritage Inventories can assist local governments to determine local conservation policies and provide information about local heritage that may be required under a local town planning scheme.

Founders' Memorial is included in the City of Rockingham's Municipal Heritage Inventory and is included in the Heritage List.

The Place Record Form describes the place as Monument designed in the Late Twentieth Century architectural period.

The Form also records:

- The condition as good.
- The integrity as high. The integrity refers to if the original intention is intact and the compatibility of current use.
- The authenticity as high. The authenticity is the extent to which the fabric is in its original state.
- *The memorial was constructed in 1979 to commemorate the founders of Rockingham and previously housed a time capsule, which was opened in 2001.*

The Founders' Memorial is allocated a Management Category B. This Management Category refers to:

The place is worthy of a high level of protection. Maximum encouragement to the owner should be provided under the City of Rockingham Planning Scheme to conserve the significance of the place. A detailed Heritage Assessment and Impact Statement should be undertaken before approval is given for any major redevelopment. Incentives to promote heritage conservation should be also be considered. (Extract from Municipal Heritage Inventory 2012).

City of Rockingham Heritage List

The City of Rockingham has created a Heritage List (non- statutory) within its Town Planning Scheme No. 2, identifying those places which are of cultural significance and worthy of conservation under the provisions of the Scheme.

There are currently 52 places on the Heritage List. The Founders' Memorial is on the Heritage List.

City of Rockingham Planning Policy 3.3.21 Heritage Conservation and Development outlines relevant considerations for development assessment and amongst other matters the policy refers to places on the Heritage List and states:

- The conservation and protection of any place which is included in the Heritage List under clause 5.4.2 of the City of Rockingham Town Planning Scheme No.2.

6.0 Historical Development

The following section outlines the historical development of the area and specifically the Post-War and Modern period, from 1950-2004. This is the period in which the Founders' Memorial was designed and installed. This section also includes relevant extracts from the Shire (City) of Rockingham Council Minutes; an online article from 2015 titled "Founders Memorial ticks again"; a Valuation of the Memorial as a piece of public art and information from Rob Forlani, a contemporary Artist and ex-student of Rockingham Senior High School. Following this section is an analysis of the information provided, to establish the development of the Founders' Memorial.

Historical Context

The Municipal Heritage Inventory contains a thematic history of the development of the City of Rockingham.

The thematic history is divided into the following sections:

- Aboriginal History of the Rockingham Area
- European History of the Rockingham Area
 - Early Colonial Period 1829 – 1850
 - Late Colonial Period 1850 – 1885
 - The Gold Boom 1886 – 1914
 - The Inter-War Years 1915 - 1949
 - Post War and Modern Period 1950 - 2004

As the Founders' Memorial was designed and erected in 1979 the historical development for the Post War and Modern period has been provided below to provide a context for the design and erection of the memorial. This information is referenced from the 2012 Municipal Heritage Inventory.

Post War and Modern Period (1950 - 2004) Rockingham

This period is characterised by the following themes:

- Holiday Destination
- Establishment of Heavy and Petro-Chemical Industry at Kwinana
- Housing the Workforce
- Stephenson Plan
- Garden Island Naval Base
- Planning the Town of Rockingham
- Population Growth
- Preserving the Environment

Holiday Destination

From the 1950s, the Rockingham area continued to develop as a popular holiday destination, particularly with Perth families, with the towns of Rockingham, Palm Beach and Safety Bay becoming well-patronised seaside resorts. To cater for increasing visitor numbers, there were dances, twice weekly cinema shows and an amusement arcade. In Rockingham town, roads were widened to cater for increased motor traffic, a move which necessitated the digging up and removal of the Jarrahdale Railway lines. In addition, the beachfront sand dunes were flattened and parks created with grassed areas, trees and shrubs. At the same time, moves were underway that would see the whole district transformed.

Establishment of Heavy and Petro-Chemical Industry at Kwinana

In 1951, meetings of the Anglo-Iranian Oil Company in London considered Western Australia as a possible location for an oil refinery, to process crude oil from the Middle East. In 1952, the State Government offered (what would become) British Petroleum 1000 acres of land on Cockburn Sound to establish its planned operation. The location was regarded positively, fronting, as it did, an almost completely land-locked deep water harbour which could easily handle the world's then largest tankers; a site with fairly level contours, hard limestone foundation and well-drained sandy topsoil. After negotiated terms between the oil company and the State Government were agreed, construction began in 1953, and was completed by early 1955.

Housing the Workforce

In order to house the workers that would be employed at the Cockburn industrial site, arrangements were made with the Rockingham Road Board to transfer 44 square miles of the northern section of its territory to form the new Kwinana Road District (from 1954) with the Refinery as its nucleus. On the hillier and better wooded eastern part of the new Road District, the State Housing Commission was to build sufficient houses to accommodate the workers who would be employed in the area. Kwinana Road District became a shire with 7 elected councillors in February 1961.

BP was followed into the area in the 1950s by BHP which began construction of a steel rolling mill in 1953 (completed in 1956), and in the 1960s by Alcoa (an aluminium refinery, begun in 1961), CBH and other heavy industries. Further north from Kwinana, Cockburn Cement established operations. These developments were encouraged by the recommendations of the 1955 Stephenson Report, which declared large portions of the

Cockburn District to be part of a special industrial zone, allowing heavy industry to produce toxic and hazardous wastes and emissions.

Although it was originally expected that most of the workers employed in the burgeoning industrial development at Kwinana would be housed in Medina, many families decided to purchase land and houses in Rockingham. To cater for an influx of population, land developers, Rockingham Park P/L, concluded an agreement with the Rockingham Shire Council to develop 1790 hectares of unoccupied land to the east of the existing town. In addition, to the north of the proposed housing project, there was to be a large shopping and business centre built, in an area to be named Rockingham Park. This new shopping centre was opened in November 1971, and expanded in September 1973, in August 1978 and October 1989. Further social infrastructure in the district was provided with the establishment in 1971 of new Shire buildings, and new sporting facilities nearby, as well as by the opening of an acute care hospital in Rockingham in May 1976.

Stephenson Plan

The new and rapid growth of Rockingham was able to be carried out in a relatively orderly manner because of its coincidence with the principles enunciated in the 1955 *Plan for the Metropolitan Region* by Gordon Stephenson and J.A. Hepburn. Consequent to this document, the Metropolitan Region Scheme was adopted in October 1963. In this scheme, there were to be corridors of development radiating out from central Perth to the north west (Joondalup), the east (Midland), the south east (Armadale), and south west (Rockingham). To harmonize with the general principles of the Plan for the Metropolitan Region, the Rockingham Shire Council drew up a Town Planning Scheme, that would take into account local circumstances and particularities. In November 1978, the Rockingham Sub-Regional Centre Study was published to allow for a detailed developmental master plan.

Garden Island Naval Base

Another major development in the Rockingham district has been establishment of a Naval Base on the southern and northern ends of Garden Island. The idea for such an establishment had been proposed as early as 1909, in an area south of Woodmans Point. After plans were drawn up, work commenced in 1911, but with the outbreak of war in 1914, the project was abandoned. During the Second World War, submarine repair facilities were set up just south of Woodmans Point. It was not until 1967, however, that the Naval Base project was revived, with planning for the scheme undertaken. Construction of the Garden Island Causeway began in the beginning of 1971 and was completed in

June 1973. The support facility was originally programmed for completion in December 1975 but a change of Government resulted in the postponement of completion for three years. A further change of government led to accelerated construction, with HMAS Stirling commissioned in July 1978.

Population Growth

The expansion of Rockingham has been reflected in the changing structure of the districts administration. From 1897 to 1953/54, the area was managed by the Rockingham Roads Board; from 1961, the Shire of Rockingham was established; and, in 1988, Rockingham was declared a City, with a population of more than 36,000 people. By 1994, the administration of the City of Rockingham relocated to new premises on Civic Boulevard, where there was also situated the Autumn Centre, Lotteries House, the Arts/Community Resource Centre and a Cinema Complex.

Preserving the Environment

Appreciation, enjoyment and preservation of the natural environment have been important concerns in the Rockingham district, especially since the 1950s. It was during this period that a number of recreation camps established by various groups - social, sporting, union, church, educational and service organizations- operated at Point Peron. In 1956, the Commonwealth leased most of the land at Cape Peron to the State Government, with the latter purchasing this land in 1964, on the understanding that it was to be used for recreation purposes, and subject to the existing recreation camp leases. Those leases expired in 1972. Further leases of 21 years were granted, with these expiring in 1993. Two further five year leases were granted, with these expiring in 2003.

During the 1990s, a large section of the City of Rockingham was set aside for a Regional Park, one of eight in the Perth Metropolitan area, which were established with the intention of protecting open space of regional significance for conservation and recreation. Rockingham Lakes Regional Park, an area of 4,270 hectares consisting of coastal areas, wetlands and remnant bush areas, and occupying approximately 16% of the area of the City of Rockingham, was established in 1997. The main areas or estates within the Park are Cape Peron, Lake Richmond, Lake Cooloongup, Lake Walyungup, Port Kennedy Scientific Park, Lark Hill, Tamworth Hill, Tamworth Hill Swamp, Anstey Swamp, and Paganoni Swamp.

It was also during the 1990s that the Shoalwater Islands Marine Park was established (on 25 May 1992), extending from Cape Peron to Becher Point, including Shoalwater Bay and

Wambro Sound. The Park includes a chain of Islands that run parallel to the coast and comprise Penguin Island, Shag Rock, Seal Island, Gull Rock, Bird Island, White Rock, The Sisters, Passage Rock, Third Rock, First Rock and Second Rock.

In the case of Penguin Island, after Mackenzie Seaforth left the Island in the 1930s, from 1948 it was leased by Safety Bay residents, McKay and McGowan. Facilities were upgraded and small huts were built on the east side. In 1951, Lawrence Gill took over the lease. He then spent large sums of money on buildings and carnival style entertainment. In later years, under Bob Carlberg's management, gas and sewerage were supplied and, in 1970, fresh water was piped from the mainland. In order to protect the environmental values of the Island, in 1987, the Department of Conservation and Land Management bought out the lease.

The Shoalwater Islands Marine Park was vested in the National Parks and Nature Conservation Authority and managed by the Department of Conservation and Land Management. The Marine Park was established to protect waters and land of special conservation value and habitats for marine and terrestrial flora and fauna. It also provided for recreational and commercial fishing and a variety of other uses consistent with conservation of the environment.

In addition to a concern for the natural environment of the Rockingham district, members of the community have also been concerned with preservation of the architectural and cultural history of the area. In 1969, the Rockingham Branch of the Royal Western Australian Historical Society was formed and began actively campaigning for the protection of the early settlers' cottages in East Rockingham, which were threatened at that time by the proposed construction of railway marshalling yards, as part of the continuing development of the Kwinana industrial area.

Shire of Rockingham Council Minutes

The following are extracts taken directly from the Shire of Rockingham Council Minutes.

Extract of Council Meeting 28 November 1978

Agenda items were suspended to meet a representative from the Apex Club, Mr. L. Smith, and Mr. D. Jane, Senior Art Teacher from the Rockingham Senior High School.

The Chairman welcomed the gentlemen to the Meeting, and invited them to supply further details on the application for the proposed construction of a monument depicting the past history of Rockingham.

Mr. Smith emphasised the reasons why the Apex Club has suggested the erection of a properly-constructed commemorative monument within the district, and the advantages he could see of having this structure in Rockingham. Mr. D. Jane outlined the type of construction envisaged and the proposed materials from which it would be constructed, emphasising that consideration has been given to using a maintenance-free material, and giving an aesthetically-pleasing design.

Mr. Smith advised that the Apex Club has considered the placement of a time capsule under the monument, in which people could be invited to place sealed envelopes for a determined price, and it was hoped that this would assist with financing of the monument.

Numerous questions were asked by Members of the Committee, and were answered by the representatives attending the Meeting.

The Chairman thanked, Messrs. Smith and Jane for attending the Meeting, and advised that they would be informed of Council's decision at a later date.

Messrs. Smith and Jane retire from the meeting.

It was recommended "That the Council agree in principle to the erection of a commemorative monument along the lines as depicted in the sketch plan and model, subject to detailed plans outlining the structural soundness of the building being submitted for approval, and the proposed location to be determined at a later date.

Also that the Council agree to the Apex Club selling envelopes to be placed in the time capsule, to assist in financing the project."

Extract of Council Meeting 27 February 1979

Apex Club of Rockingham. Re erection of a "Founders' Monument" which would incorporate a town clock, and requesting Council's assistance with various matters.

It was recommended "That this matter be referred to Council's Consultant Engineer to check the strength of the proposed tower, and the other matters be deferred pending receipt of this advice."

Extract of Council Meeting 27 March 1979

Apex Club of Rockingham. Re proposal to erect a Founders Monument.

It was recommended "That the Apex Club be written to advising Council suggest that the Founders Monument be erected on the northern traffic island in Railway Terrace at the intersection of Rockingham Road."

Extract of Council Meeting 24 April 1979

Apex Club of Rockingham. Re position of proposed "Founders' Monument."

It was recommended "That this matter be differed pending a meeting between representatives of the Club and the General Purpose Committee, to be held at 4.30pm on Thursday, April 19th, 1979."

4.35pm Apex Club of Rockingham.

The Chairman welcomed Messrs. L. Smith and E. Smeding of the Rockingham Apex Club, who were attending the Meeting to discuss the proposed erection of a "Founders' Monument."

The matter was discussed generally, and the sites previously mentioned were considered with the Apex representatives, who then retired from the Meeting.

6. It was recommended "That the Founders' Monument and clock tower be erected on the traffic island at the intersection of Railway Terrace and Kent Street, Rockingham, and that 2 parking bays be deleted to enable the monument be to erected slightly back from the intersection. "

Extract of Finance, Works & Parks Committee Meeting 18th July 1979

Item 5.6. Apex Club of Rockingham. Re medallions for presentation in recognition of leadership, four to be presented to Summit Club Members, and one to Mr. D. Jane in recognition of this work towards the Founders Memorial. In conjunction with the Recreation Officers report a letter was tabled from the Apex Club.

It was recommended "That five medallions be made available to the Apex Club as requested".

Information from the records of the Rockingham and Districts Historical Society

26th June 1979

Australia Post

Advising approval is gained for installation of single phase meter in the Post Office building situated in Railway Terrace to allow connection of the clock in memorial.

City of Rockingham Public Art Valuation 2015

The valuation form records the construction date as 1979 and the artist as Daryl Jane. The form records the construction as brick, clock parts, reinforced fiberglass and resin impregnated bronze pigment. The condition is stated as 'good' with no apparent damage to the structure and the surface is recorded as faded.

It is noted that a new or reconditioned plaque is required and it is recommended that further advice is sought from the artist.

Under the remarks section it is noted that the sails are not the original design but rebuilt approximately 20 years ago when the work was relocated and another recoating is strongly recommended to ensure the continued good condition of the work.

2015 Founders' Memorial Clock Restoration

The Following information references an online article written for "The Western Australian." "Founders Memorial Ticks Again" written by Arran Morton from the Sound Telegraph for "The Western Australian" online database, 23rd September 2015 12:02 PM

It has been more than two years since Rockingham's Founders Memorial clock worked properly.

Now the hands of time will tick once more thanks to Shoalwater amateur horologist Jay Macfarlane.

Lifelong clock enthusiast Mr Macfarlane said he had often wondered why the iconic clock-tower at Railway Terrace, which was erected in 1979, was out of order.

He said he decided to take matters into his own hands and last week approached City of Rockingham with a plan to fix the neglected mechanism.

"It upset me every time I passed it because it is such a special thing for the city," Mr Macfarlane said. "It had been neglected and it was a shame - I thought it must have been quite easy to fix with modern technology."

Rockingham Mayor Barry Sammels said the clocktower, which has two time pieces, had suffered intermittent faults over the past two years.

Cr Sammels said the City handed the clocks to Mr Macfarlane to assess and he quickly spotted the fault and fitted a battery-operated mechanism and new hand pieces.

"The original clocks are battery powered motors which are prone to time displacement and a short operating life," Cr Sammels said.

"Mr Macfarlane did not charge for his time and only requested reimbursement for his materials totalling \$150.85.

"The long-term replacement solution from Simplex Time is estimated to cost about \$6000."

Mr Macfarlane said he had long held an interest in time-keeping devices and liked to restore antique clocks in his spare time.

He said he was pleased the City provided an electrician to work alongside him during the restoration process.



Reference:

Morton. A 2015, "Founders Memorial Ticks Again", Photograph, viewed March 2017,
<https://thewest.com.au/news/wa/founders-memorial-ticks-again-ng-ya-393783>

Information from Rob Forlani

Contemporary artist and ex- student of Rockingham Senior High Student, Rob Forlani, was contacted by Stephen Carrick Architects to provide detail on the design of the Founders' Memorial and the artist Daryl Jane.

(The following information is referenced from Appendix C.)

Mr Forlani commented that Daryl Jane had been a mentor and a significant influence on him as an artist. Mr Forlani recalled strong memories of working on the Founders' Memorial with Daryl Jane and other select students from Rockingham Senior High School.

Mr Forlani clarified that the Rockingham Senior High School Students and Daryl Jane had produced two separate pieces that were based on the 'Founders' and 'nautical' themes. The bronze sails were originally completed and located at the Rockingham Senior High School and the main relief was located on the monument on the intersection of Kent Street and Railway Terrace. Mr Forlani said that the design for the two pieces took a couple of years and he believed that the students commenced working on the project with teacher Daryl Jane in 1977. Rob Forlani, was unaware when the Bronze sails were relocated from the Rockingham High School to the Founders' Memorial in the town centre. He commented that it must have been "after my time" (after he graduated from Rockingham Senior High School and moved away from the area).

Mr Forlani, confirmed that the Founders' Memorial was always to be a clock, and the relief design was to accompany the clock. The design of the Founders' Memorial clock was started by the students. A contractor/ specialist was hired to produce the clock (the specific contractor/ manufacturer is unknown).

Mr Forlani, confirmed that the students were not involved in the design of the brick pier. Mr Forlani, described the brick pier as a plinth to the Founders' Memorial relief and clock.

Stephen Carrick Architects asked Mr Forlani to clarify if the Memorial had ever been re-erected or relocated. Rob Forlani confirmed the location of the Founders' Memorial was "ear marked" from the beginning and that the memorial has always been located on the intersection of Kent Street and Railway Terrace in Rockingham. Rob Forlani re-iterated his strong memories for the project and commented that the Memorial's location in Rockingham has personal significance to him.

7.0 Analysis of Documentary Evidence

The analysis below discusses each physical component of the Founders' Memorial and examines the documentary evidence for each section.

The Bronze Relief

The Bronze relief of the Founders' Memorial was designed by Rockingham Senior High School students and Daryl Jane. Select students of Rockingham Senior High School and Daryl Jane started to develop the designs for the Relief and Bronze Sails in approximately 1977. Once developed the proposal for the Monument was put forward to the Rockingham Council in 1978. The relief and sails were completed for the Monuments erection in 1979.

The Bronze Sails

The 2015 art valuation of the memorial assessed that the sails are not the original design but rebuilt approximately 20 years ago. It is understood by Stephen Carrick Architects, that this statement is only partially correct. The bronze sails and the bronze relief around the brick plinth were two separate pieces, based on the Founders' and nautical theme. Both were designed and completed during the same period by artist, Daryl Jane, and select students from Rockingham Senior High School. The sails; however, when finished were originally located at the Rockingham Senior High School and the relief was located on the Founders' Memorial brick plinth. These pieces were evidently combined at a later date (c1995) as the 2015 art valuation states. Fine Art Conservator, Gordon Hudson, who previously has valued public pieces for the City of Rockingham, advised Stephen Carrick Architects that the bronze sails had originally been separate to the bronze relief on the Founders Memorial and the pieces were brought together at a later date.

The Clock Face

The "Founders Memorial Ticks Again" article features a photo taken by Arran Morton of Jay Macfarlane standing next to the Founders Memorial Clock in 2015. This image (Appendix D) shows a different and minimal clock face covered in clear perspex compared to the current white plastic clock face covered in clear perspex on the Founders' Memorial (Photos shown in Appendix A). It is unknown whether the 2015 clock face in Appendix D is the original clock face for the Memorial or if there were prior changes to the clock face. There is no written documentary evidence of any clock face changes to the Memorial.

Artist, Rob Forlani, who was involved with the design of the Founders Memorial, confirmed that it was part of the initial design intentions that the Founders' Memorial include a clock.

Rockingham Council minutes from February 1979, confirms this intention to include a clock. Rob Forlani commented that students did produce a design of the original clock face but the making of the clock was out sourced.

The Brick Pier

The minute extracts state that the Rockingham Council was concerned with the structural soundness of the Commemorative Monument and Daryl Jane had considered materials that were aesthetically pleasing and low maintenance. Other than pragmatic solutions for the structure of the Monument there appears to be little or no artist involvement with the design of the brick pier.

Plaque and Signage

There is limited documentary evidence on the plaques and signage of the Memorial. It is presumed that both pieces are original components to the memorial.

The Location

It is possible to misinterpret the use of the term 're erection', 're position' and the 're proposal to erect the Founders' Memorial in the council minute extracts. On examination, the term 're' appears to be a shortening of 'in regards to' and does not refer to the Founders' Memorial being 're-erected, repositioned or relocated'. Rob Forlani confirmed that the intersection of Railway Terrace and Kent Street was always 'ear marked'. This location was confirmed in the 24th of April Council Minutes in 1979, where the minute state that *"the Founders' Monument and clock tower be erected on the traffic island at the intersection of Railway Terrace and Kent Street, Rockingham, and that 2 parking bays be deleted to enable the monument be to erected slightly back from the intersection."*

It is understood that the sails component of the Memorial was relocated from the Rockingham Senior High School to the Founders' Memorial in approximately 1995.

8.0 Description of the Place

Streetscape

The Founders' Memorial is located at a prominent intersection in Rockingham in close proximity to the Rockingham Foreshore. The intersection is the junction of Railway Terrace, Patterson Road, Kent and Parkin Streets. It is sited in a traffic island that extends to Rockingham Beach Road and has angled parking on each side of the street.

The adjacent area is comprised of one and two storey commercial development with street car parking and shopping centre parking. The area adjacent to the memorial is brick paved. The overall streetscape is relatively neutral with some tree planting to the paved area.

Place

The following description is referenced from the Municipal Heritage Inventory Place Record Form:

A square brick pier, approximately 4m high and 1m wide, located in a prominent position at the intersection of Railway Terrace and Parkin Street. The uppermost portion of the pier is faced with bronze relief panels depicting nautical scenes, and is adorned with a bronze sculpture in the form of a sailing boat. A clock and an inscription are located on the southern face of the pier.

There are three sections to the memorial. The lower section is a pier constructed of a cream/blonde brick laid in stretcher bond. The plan is square. To the top of the pier are bronze panels to all four sides and on top of the pier are bronze sails. There are two clocks with perspex covering. The plaque on the south elevation states:

ERECTED IN 1979 BY
STUDENTS OF ROCKINGHAM SENIOR HIGH SCHOOL,
SUPPORTED BY APEX & THE COMMUNITY.
COMMEMORATING THE PIONEERS OF THIS DISTRICT
& THE 150TH ANNIVERSARY OF
THE ARRIVAL OF CAPTAIN JAMES STIRLING
IN THE VESSEL PARMELIA
BRINGING THE FIRST COLONISTS
TO WESTERN AUSTRALIA.

UNVIELED BY
MRS. N. TAGGART

DESIGNED BY
MR. D JANE

The City of Rockingham Public Art Valuation 2015 records the base as 1 metre square and 3 metres high. The sculpture is recorded as being 2.5 metres high.

9.0 Significance

The following Statement of Significance is an extract from the Municipal Heritage Inventory Place Record Form for the Founders' Memorial.

The Founders' Memorial has cultural heritage significance for the following reasons:

- the memorial has an attractive and distinctive form, featuring a series of bronze relief panels on each face and is adorned with a stylised bronze sculpture in the form of a sailing boat
- the memorial is valued by the community as a commemoration to the founders of Rockingham and formerly contained a time capsule dating from 1979 and opened in 2001

The Founders' Memorial has aesthetic, historic and social heritage values at a local level.

10.0 Proposal

The Rockingham Beach Foreshore Revitalisation, Stage One, consists of the following elements:

1. An expanded Wanliss Street car park;
2. Upgraded Railway Terrace;
3. Pedestrian Friendly Beach Plaza;
4. Boardwalk; and
5. Associated Intersection Upgrades.

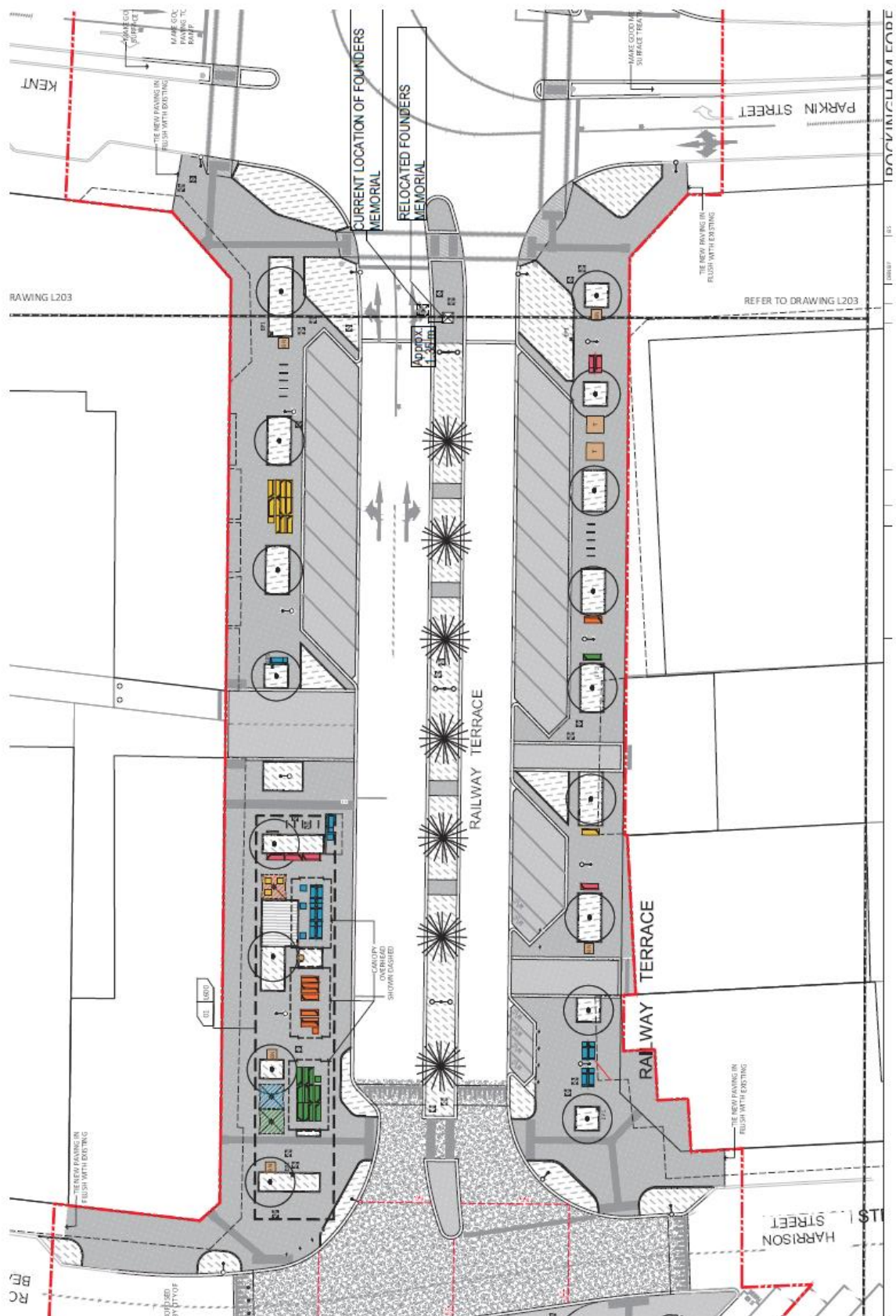

Site Plan- Proposed by The City of Rockingham (Not to scale)

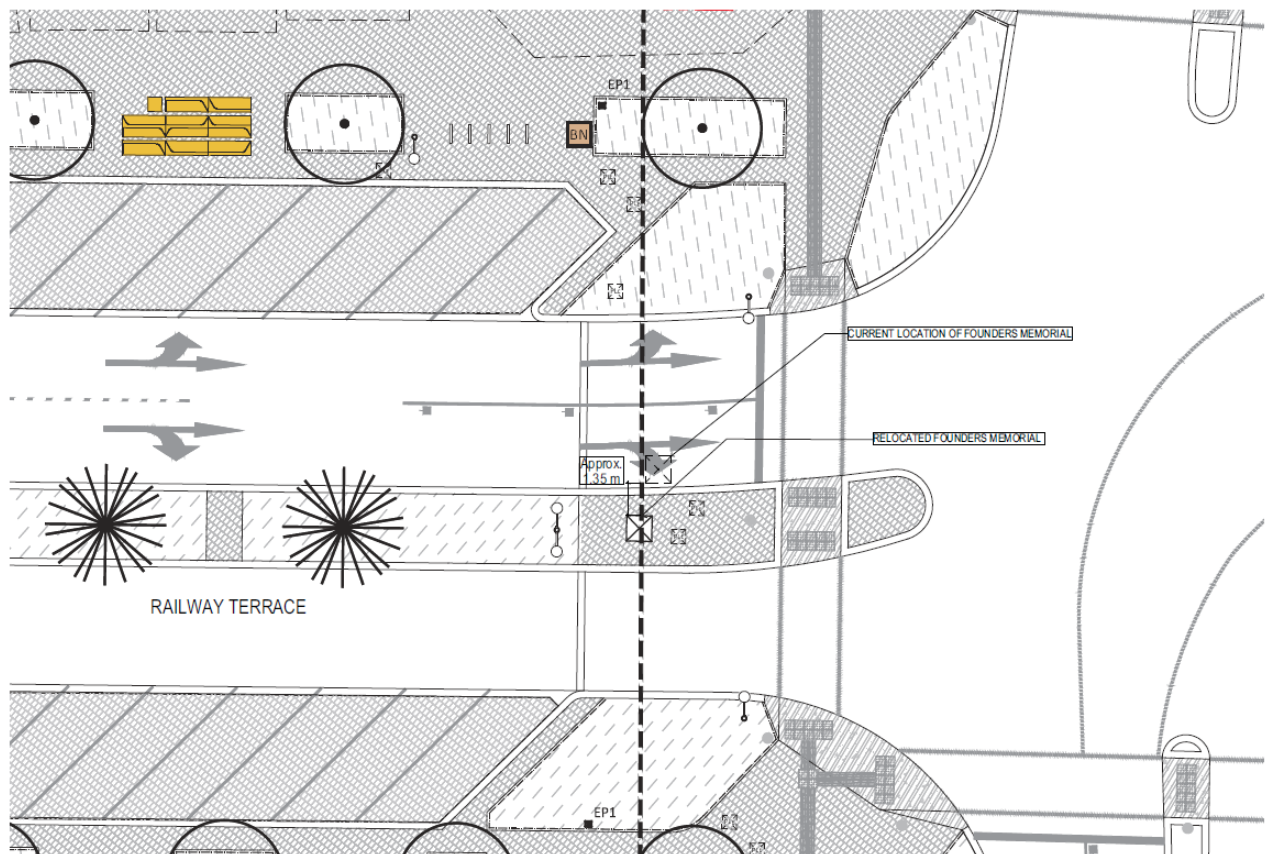

Detailed Site Plan (Not to scale)

Source: City of Rockingham

The proposal illustrates the following with regard to the Founders' Memorial:

- The repositioning of the Founders' Memorial approximately 1 metre from its current location; and
- Removal of the paved traffic island and angled parking and replaced with landscaped traffic island.

11.0 Statement of Heritage Impact

The following sections are presented to address specific areas where the proposal may impact on the heritage values of the place.

The proposals impact is assessed against the:

- Cultural heritage values of the place; and
- Development Control Principles.

The impact comments are presented by addressing the proposal as three distinct items:

1. Overall masterplan;
2. Relocation of the memorial; and
3. Aesthetic changes to the memorial.

Cultural heritage values of the place

Aesthetic Value

The Memorial has an attractive and distinctive form that features a series of bronze relief panels on each face and is adorned with a stylised bronze sculpture in the form of a sailing boat.

Comment

1. Overall masterplan

The masterplan shows the Founders' Memorial being relocated, approximately 1metre from its current location. Improvements are planned for the streetscape surrounds to the memorial. The relocation of the memorial allows for Railway Terrace to be widened and positions the Founders' Memorial to the centre of the new traffic island.

2. Relocation of the Memorial

If the Founders' Memorial was repositioned, the aesthetic values of attractiveness and distinctive form would not necessarily be impacted as they would still be able to be viewed and interpreted in approximately the same location.

3. Aesthetic changes to the memorial

If changes to the Founders' Memorial, such as rendering the face brick or removal of the brickwork, were proposed then it is likely that these changes would not have an impact on the aesthetic values. There is limited evidence that the face brick pier was designed by the artist. Therefore, changes to the base could be considered or a new base, that is sympathetic to the Memorial's material palette, could be incorporated.

Whilst the inclusion of a clock to the memorial is a critical element of the memorial an alternative clock face design could be designed as the current clock is not original and it is considered to have a negative impact on the memorials aesthetics.

Social and Historical

The memorial is valued by the community as a commemoration to the founders of Rockingham and formerly contained a time capsule dating from 1979 and opened in 2001.

Comment

1. Overall Masterplan and Relocation

If the Founders' Memorial was relocated to another appropriate prominent location the social and historical values are likely to be impacted as the selection of the initial location was a matter for consideration and approval by the Shire of Rockingham Councillors in 1979.

The Burra Charter for places of cultural significance states under Article 9 Location that:

The physical location of a place is part of its cultural significance. A building, work or other component of a place should remain in its historical location. Relocation is generally unacceptable unless this is the sole practical means of ensuring its survival.

The repositioning of the Founders' Memorial, approximately 1metre away from its current location as proposed in the Masterplan, whilst technically could be argued as being relocated in terms of conservation practice a more practical interpretation is that the Memorial is simply being repositioned as part of the redesign to upgrade the Foreshore precinct. The proposal maintains the Founders' Memorial in a central and prominent position on Railway Terrace, ensuring that the Memorial remains accessible and prominent to the community and visitors.

2. Aesthetic changes to the Memorial

The documentary evidence confirms that there are three distinct elements to the memorial. The sails, the relief and the brick pier with the clocks. The sails and the relief are designed elements by the artist, Daryl Jane and Rockingham Senior High School students. It is understood that the brick pier was not an artist designed element. There is evidence that the clock face is not original and therefore an alternative clock design could be considered. The presence of a clock face has been key to the memorial throughout and therefore a time device should remain part of the Memorial.

The material selection and presentation of the memorial are characteristic of the Post War and Modern period. The materials and design could be considered as forming part of the social and historic values of the place. In our opinion, whilst the clocks and brick pier are representative of the time, they are not of the same level of significance as the artwork. Changes to the clock faces and brick pier could be considered without necessarily impacting on the cultural heritage values of the artwork.

Development Control Principles

The City of Rockingham's Planning Policy 3.3.21 Heritage Conservation and Development contains development control principles. The Policy states that these principles' must be applied in considering applications for planning approval in relation to a place entered in the Heritage List under the City of Rockingham Town Planning Scheme No.2.

The Policy states that the weight given to heritage as a consideration will vary, depending on the degree of significance of a place or area, and relevant economic, social or environmental factors that may apply.

Principle 1

Development should conserve and protect the cultural heritage significance of a heritage place based on respect for the existing building or structure, and the least possible change to the significant fabric.

Comment

1. Relocation of the memorial

The Masterplan shows the Founders' Memorial being repositioned to a position approximately 1m from its current place. If the Founders' Memorial was relocated to another appropriate prominent location within the City it could be argued that the overall cultural heritage values would be impacted as the location is an important element contributing to the place and this would involve some changes to the fabric. As the Memorial is remaining at the intersection it is considered that this principle is being satisfied.

2. Aesthetic changes to the Memorial

If changes to the Founders' Memorial, such as rendering the face brick, were proposed these changes could be deemed as involving a change to the building fabric and therefore not respecting the existing structure. However, as it is understood that the brick pier was not an artist designed element, it is our opinion that aesthetic changes could be made without impacting on the heritage values of the place. This principle is being satisfied.

Principle 2

Alterations and additions to a heritage place should not detract from its significance and should be compatible with the siting, scale, architectural style and form, materials and external finishes of the place. Compatibility requires additions or alterations to work with the original fabric rather than simply copying or mimicking it.

Comment

1. Overall Masterplan

The improved streetscape includes additional tree planting which will provide more shade and will reinforce an avenue presentation. This will enhance the setting for the Memorial. The proposed repositioning of the memorial maintains the Memorial's prominence being centred on the improved avenue.

2. Aesthetic changes to the Memorial

If aesthetic changes to the Founders' Memorial, such as rendering the face brick, were proposed then it is suggested that they are carefully designed and considered to ensure that they do not detract from the significance of the place. The Memorial base would benefit from professional advice with regard to the form, materials and external finishes.

Aesthetic changes to the clock face may be possible as the clock face is not original and currently detracts from the Memorial's overall aesthetic.

The Memorial artist Daryl Jane should be liaised with if aesthetic changes to the memorial is proposed.

Principle 3

In some cases, the conservation and protection of a heritage place may require a change of use to ensure a reasonable beneficial use or return. Sympathetic adaptation and change of use should be supported in such cases.

Comment

1. Relocation of the Memorial

Relocation of a heritage place is generally unacceptable, however it is permitted if it is the sole practical means of ensuring its continued survival. As the Founders' Memorial is being repositioned approximately 1 metre away from its current location, it remains in close proximity to its current location and therefore relocation is reasonable.

2. Overall Masterplan

The improved streetscape presentation is a sympathetic adaptation adjacent to the Memorial.

3. Aesthetic changes to the Memorial

No change of use is proposed to the Founders' Memorial. Sympathetic adaptation, guided by professional advice, of the Memorial base is reasonable as the base is of low significance. The Memorial artist Daryl Jane should be liaised with if aesthetic changes to the Memorial are proposed.

Principle 4

Development should be in accordance with any Planning Policies relating to heritage.

Comment

The proposed masterplan is considering relevant planning policies such as the implications of the Heritage List and the Development Control Principles in the commissioning of this Heritage Impact Statement.

Principle 5

Where a Conservation Plan has been prepared for a place, development must be in accordance with the conservation policies under the Conservation Plan.

Comment

A Conservation Plan has not been prepared for the Founders' Memorial.

Principle 6

Demolition of a heritage place with exceptional or considerable significance is rarely appropriate and should require the strongest justification. Demolition of a heritage place with moderate or low significance should be avoided wherever possible, although there may be circumstances where demolition is justified. The onus rests with the applicant to provide a clear justification.

Comment

Demolition of the Founders' Memorial is not proposed.

Principle 7

Demolition approval should not be expected simply because redevelopment is a more attractive economic proposition, or because a building has been neglected. Consideration of a demolition proposal should be based upon the significance of the building or place; the feasibility of restoring or adapting it, or incorporating it into new development; and the extent to which the community would benefit from the proposed redevelopment.

Comment

Demolition of the Founders' Memorial is not proposed.

The Policy also states that:

Any person or organisation who is considering or proposing to develop or alter a heritage place should seek advice from a qualified heritage architect or heritage consultant prior to progressing any application.

Comment

The City of Rockingham has engaged a qualified heritage architect to provide advice as part of their process and considerations for the Founders' Memorial as part of the Rockingham Foreshore Masterplan.

12.0 Conclusion

Founders' Memorial is a place of cultural heritage significance that is included in the City of Rockingham's Municipal Heritage Inventory and Heritage List.

The Memorial was designed by Daryl Jane and select students from Rockingham Senior High School and erected in 1979. The Shire (City) of Rockingham considered and approved the design and the location of the structure. The place's cultural heritage values have been considered as part of the preparation of the Municipal Heritage Inventory and the place was assessed as worthy of a high level of protection with maximum encouragement being provided to the owner to conserve the significance of the place.

The Rockingham Foreshore Masterplan is focusing on improving the amenity of Railway Terrace, Beach Plaza and Boardwalk precinct. The improvements are aimed at being pedestrian friendly and propose to reposition the Founders' Memorial approximately 1 metre from its current location.

This Heritage Impact Statement has considered the available documentary evidence; has liaised with the Rockingham District Historical Society; undertaken a site visit to understand the place and context; has liaised with a former Rockingham Student involved with the design of the memorial; considered the proposed masterplan as well as the proposed relocation and aesthetic changes to the memorial and has evaluated the potential impact of these changes on the cultural heritage significance of the place. In considering the impact the heritage values of the Memorial and relevant heritage planning policy have been evaluated.

The relevant Burra Charter Article on location is clear that the physical location of a place is part of its cultural heritage significance. A place should remain in its historical location and relocation is generally unacceptable unless this is the sole practical means of ensuring its survival.

The Rockingham District Historical Society support the retention of the Memorial in its current location with no changes to the building fabric.

This Heritage Impact Statement has concluded that the cultural heritage values of the place will not be impacted by the proposed repositioning of the Founders' Memorial in line with the Foreshore Masterplan. Repositioning the Founders' Memorial, approximately 1 metre away from its current location does not detract from the place's significance. The proposal maintains the Founders' Memorial's central and prominent position on Railway Terrace and the proposed position will continue to be accessible to community members and visitors.

Altering the Founders' Memorial's brick pier or incorporating a new base would not necessarily impact the cultural heritage values of the place if done in a sympathetic manner with the guidance of professional advice.

13.0 Recommendations

- The repositioning of the Founders' Memorial approximately 1 metre from its current location is supported;
- Consideration should be given to investigating the appropriate conservation of the existing plaques;
- The Founders' Memorial artist, Daryl Jane should be liaised with if changes to the memorial design are proposed.
- Consideration should be given to investigating the inclusion of appropriate working clock designs to replace the existing clocks on the monument;
- If the brick base is proposed to be altered or a new base is proposed, it is recommended that it is undertaken in such a manner to ensure that it is sympathetic to the designed bronze relief and sails;
- If a new base is proposed, then it is suggested that an artist is engaged to assist and guide the overall design and composition of the clock tower and artwork;
- Consideration should be given to advertising for former Rockingham Senior High School students who were involved in the design of the memorial, requesting any information related to the artwork; and
- Consideration should be given to appropriate lighting of the Founders' Memorial as part of the works for the Foreshore redevelopment.

Appendix A - Photographs

All photographs were taken by Stephen Carrick Architects



North – West Elevation



South - East Elevation



South – West Elevation



Bronze Relief



Plaque



Bronze Sails

Appendix B- Masterplan Design

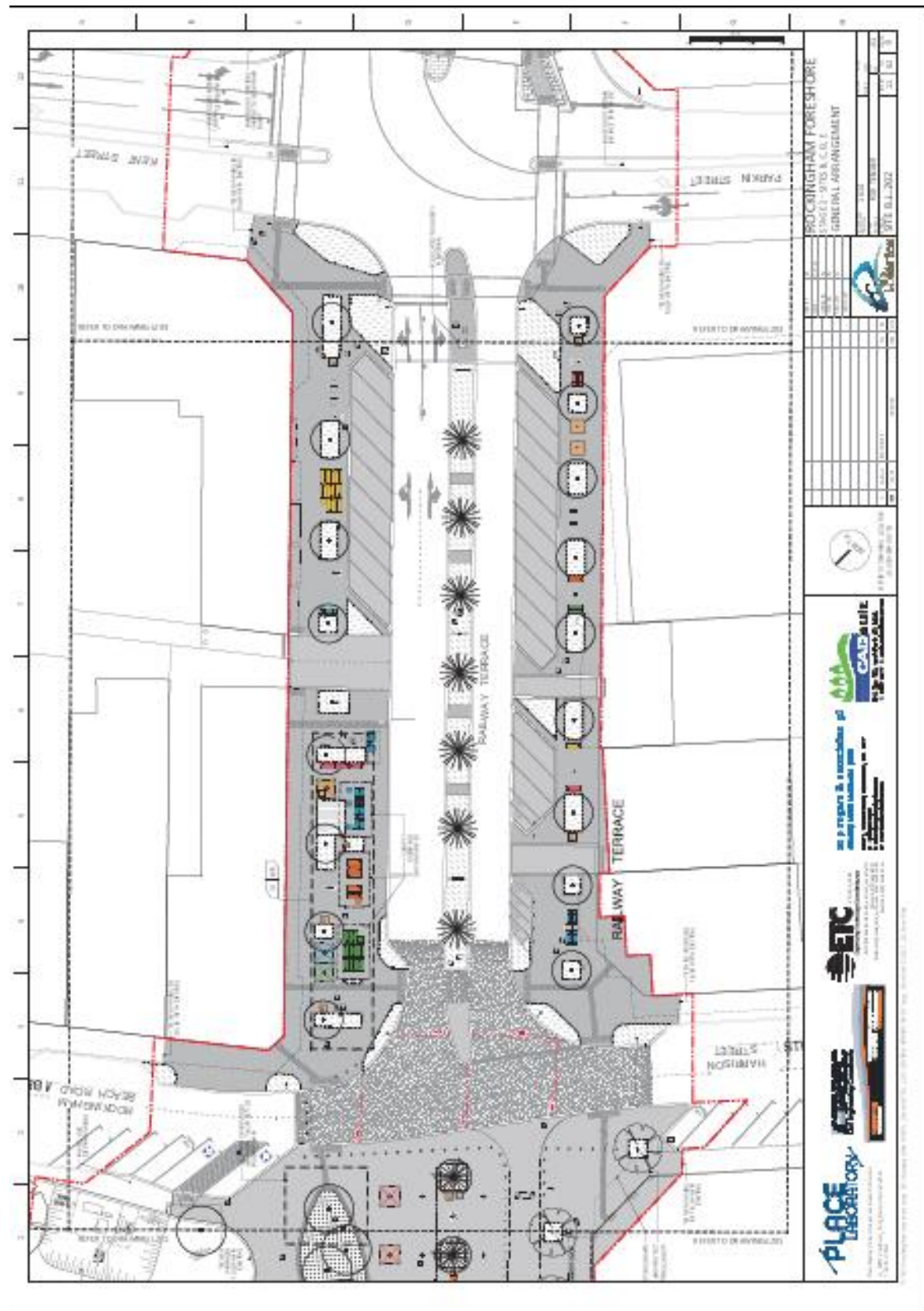

Appendix C- Phone Interview with Rob Forlani



t: 0457 309 201
a: PO Box 578, Scarborough WA 6022
e: stephen@stephencarrickarchitects.com.au
w: stephencarrickarchitects.com.au

file note

Site: Founders Memorial

Date: 31 March 2017

Rob Forlani (Contemporary artist and Former Rockingham Student. As a student, Mr Forlani was involved with the design and production of the Rockingham Founders' Memorial) and Nicola Marchesi (Graduate, Stephen Carrick Architects) had a phone conversation to discuss the history of The Founder's Memorial and Specifically Rob Forlani's involvement as a student.

Item	Question	Answer (Answers have been paraphrased from conversation with Rob Forlani)
Sails	"There has been some questions over whether the sails were originally done for the Founders' Memorial on the intersections of Kent St and Railway Terrace, do you know if they were indeed separate pieces or not?"	Yes, The Sails were originally done for the school and must have been relocated to the Memorial later. "That must have been after my time". Both were done at the same time with the similar nautical theme in mind.
Relief	"Was the design of the relief the main part of the project?"	Yes, Students developed sketches for the relief. We started in, 1977 [possibly 1978] and it took a couple of years. Daryl said the design was to accompany the clock.
Clock	"So, the Reliefs were for the clock, were you involved in the design of the clock?"	Design for the clock face was done by the students. The clock was custom made by a specialist/contractor
Pillar	Was the brick work design by Daryl Jane or the Student's?	No design work was done by the students for the pillar. The pillar was simply acting as a 'plinth' for the work.
Location of Memorial	"Do you know if the Founders' memorial was ever relocated?"	The memorial has always been in the same location. There are strong student memories for the memorial and its significance to the town. Memories of the time and place. Location was always landmarked to the school students by Daryl Jane and council.
Daryl Jane		Daryl Jane has been significant influence on him as an artist. Strong memories are held for that period and Daryl's contributions as a teacher and as a mentor to the selected students on the Founder's Memorial Project.