

Rockingham Arts Centre

2025 Exhibition Application Information Pack



rockingham.wa.gov.au



2025 Exhibition Application Information Pack

Applications open: Monday 27 May – Friday 19 July 2024

The Rockingham Arts Centre (RAC) is currently seeking proposals for their 2025 exhibition period. Applications from individual artists, groups, curators, and institutions are encouraged. An exhibition application is required from all applicants.

About the Rockingham Arts Centre

Located in a prime position at 11 Kent Street, Rockingham, the RAC is located in a refurbished ambulance centre. In 2022, the Centre underwent an extensive refurbishment to bring it in line with the needs of exhibiting artists. The gallery consists of a main exhibition space and an adjacent smaller project and workshop space. Successful applicants will exhibit in the main gallery with the project space available for workshops and other art related events. The project space also has the capacity to host smaller exhibitions.

How to apply

[Complete the online application form](#)

Detailed information about applying and exhibiting can be found below. If you have further questions, please contact Gallery Curators prior to submission:

Ms Jude van der Merwe, jude@judevm.com or Ms Clare Stroud strouddesign@inet.net.au

Leah Robbie, Community Development Officer (Art Collection and Programs)
artscentre@rockingham.wa.gov.au or 9527 0734

Key dates

- Applications open – Monday 27 May 2024
- Applications close – Friday 19 July 2024
- Applicants will be advised that their application has been received within five days of submission.
- Panel assessments will commence the first week of August 2024.
- Applicants will be advised of their proposal outcomes within six weeks of the closing date.

Proposal advice

The selection panel are looking for proposals that extend the applicants professional practice and are reflective of contemporary issues and ideas. People of Aboriginal and Torres Strait Islands and those from diverse cultural backgrounds are encouraged to apply. We are committed to ensuring that all artists have equal opportunities to access, engage and participate in the Centre's activities.



2025 Exhibition Application Information Pack

Practical tips for your application

- Write clearly without jargon – get your idea across as simply and clearly as possible.
- Use high quality images to support your application. These should include past, relevant work as well as images indicative of the work you plan to exhibit.
- Pay attention to the dimensions and capabilities of the exhibition space (refer to the main gallery floor plan attached here for reference).
- Provide an up to date, relevant CV for yourself or, if the application is on behalf of a group, a group biography, including aims and aspirations, purpose, and images from individual group participants.

Selection criteria

The selection panel will assess applications based on the following criteria:

- Conceptual – are the ideas under-pinning the work relevant and coherent.
- Technical – do the images demonstrate technical abilities within the chosen medium(s).
- Audience – would a wider audience be engaged through workshops, artists talks etc.
- Ingenious – is the project inventive and original.
- Suitability – have the opportunities and constraints of the RAC space and/or communities of Rockingham been considered.

Exhibition information

- Exhibitions generally run for up to three weeks (three weekends).
- Community group exhibitions generally run for one week (one weekend).

Opening events for the exhibition program can take place during the following times:

- Thursday or Friday evenings from 6pm - 8pm.
- Saturday or Sunday with the gallery closing at 4pm.

Please Note: Sunday events are best held after 1pm due to lack of parking. The Rotary Markets are held in the adjacent carpark on Sunday mornings up until 12pm.

Installation can commence at 12 noon on the Monday prior to the exhibition opening. De-installation can take place after 4pm on the final Sunday of the exhibition period. De-installation is to be completed no later than 12pm on the Monday following the exhibition closure.

The City reserves the right to extend or shorten exhibitions depending on the application and calendar constraints.



2025 Exhibition Application Information Pack

Gallery Hours:

10am – 4pm, Wednesday to Sunday

Closed Public Holidays

Exhibition Space

See plan below (Please note: this plan is not to scale and ceiling mount locations are not an accurate representation of space or location).

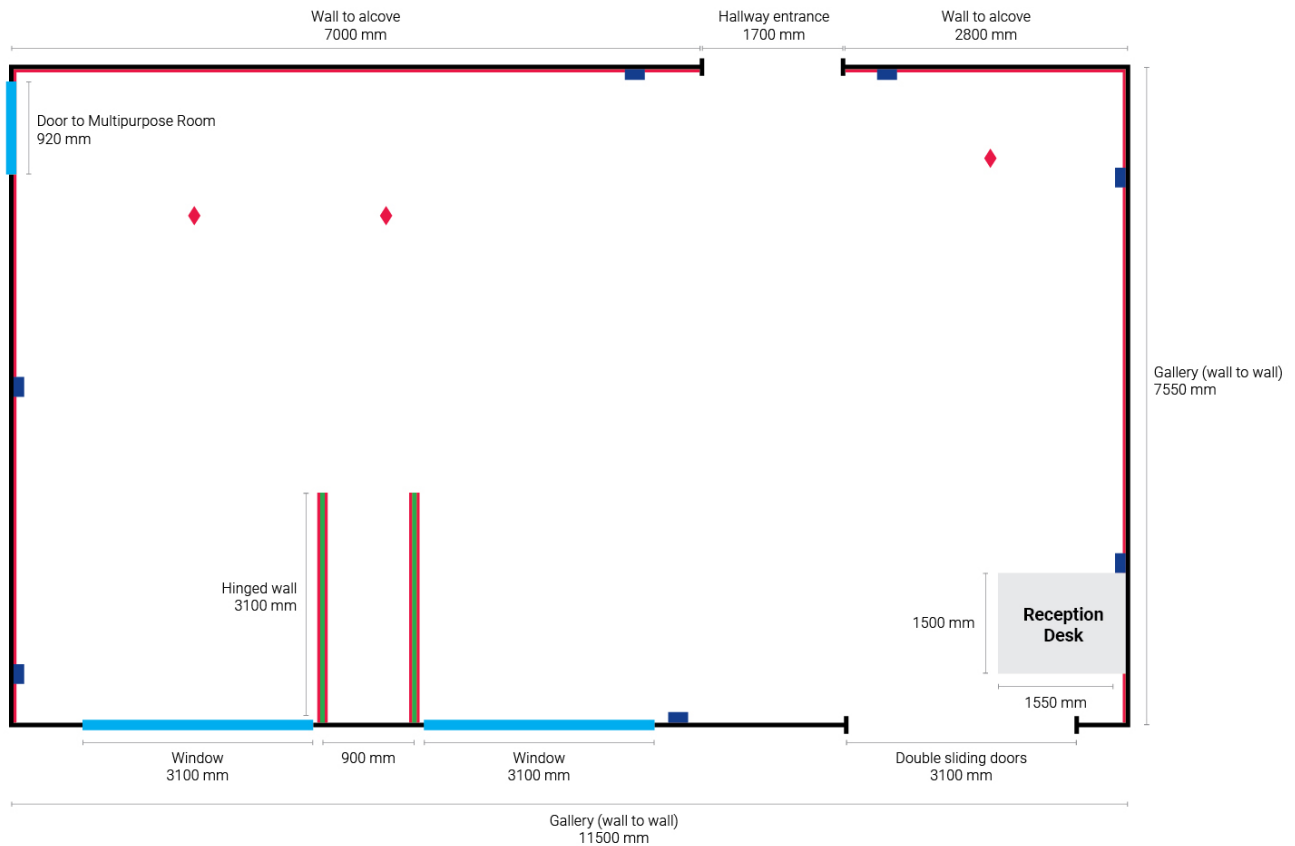

Legend

- Fixed wall – 10 mm thick plasterboard
- Hinged wall – 13 mm thick plasterboard
- Opening for door or window
- Double power point
- Artiteq Click Rail
- Ceiling mount hanging point

↑ Ceiling height
3200 mm

↑ Hinged wall height
3000 mm

↑ Artiteq Click Rail height
Wall – 3050 mm

↑ Artiteq Click Rail height
Hinged wall – 2850 mm

⊠ Approximate gallery floor area
86 m²



rockingham.wa.gov.au



2025 Exhibition Application Information Pack

- The main gallery has two large swinging walls that can be positioned across the facades main windows to create more hanging space and to reduce light in the gallery, or they can be rotated to 90 degrees out from the wall to break up the internal space, allowing more natural light in.
- A gallery hanging system, inclusive of two (2) types of drops/wires and clutch hooks are available.
- There are three (3) anchoring panels located in the ceiling for suspended works to be displayed from. There are four (4) points in each location. Each of these points has a maximum weight limit of 20 kg per point with a total of 80 kg per location.
- The space is fitted with gallery style track lighting. Please note that lighting adjustments will be done in consultation with the Curator/s and/or other gallery staff.
- Direct fixing to the walls is discouraged. Any direct fixing will require pre-approval from the City and will only be approved if the artist commits to filling and re-painting the walls on de-installation. Artwork must weigh under 1 kg each.

Equipment:

- Plinths – there are nine (9) plinths of varying dimensions
- AV equipment – data projector

Inclusions:

- With the exception of exhibitions held by community groups the Curator/s will assist artists to develop their exhibition plan and install their works.
- Artists are strongly encouraged to reach out to the Curator/s to discuss their exhibition plan well in advance of the installation date.

Installation and De-installation

- Installation will begin on a Monday generally at 12 noon and will run for approximately two days.
- The RAC Curator/s are responsible for the final presentation and approval.
- De-installation can begin at 4pm on Sunday and continue to 12pm on Monday.
- Assistance and support with installation will be provided on agreement with the Curator/s and will be treated on an as-needs basis.
- All works to be hung on walls must come with D-rings ready for installation. All other needs must be discussed and agreed upon with the Curator/s prior to installation.
- Artists must make good all walls and fittings immediately following de-installation.
- As storage is limited, the delivery of works should be discussed and agreed with the Curator/s prior to installation. Upon de-installation of the exhibition all artworks are required to be removed as works cannot be stored at the Centre post de-installation.



2025 Exhibition Application Information Pack

Gallery fees, costs and inclusions

- Gallery hire fee \$100 (including GST) per week for community artists and community groups.
- Under certain circumstances the City can assist with insurance for those without Public and Products Liability Insurance.
- There is a commission of 20% plus GST on all sales for selected professional artists. Sales of artworks will be managed by the RAC.
- Community run exhibitions are required to handle their artwork sales. A commission will not be taken in this instance.
- Based on the recommendations of the selection panel a select number of applicants will be awarded artist fees of up to \$1,000 per exhibition. They will not be required to pay the gallery hire fee. As part of this fee, the artists are required to present an artist talk or run a public program event.
- In the event that an artist damages the main gallery space, repair fees of up to \$300 may be charged.

Service	Selected Professional Artist/s	Selected Community Artist/s	Selected Community Group
Gallery Hire Fees	N/A	Yes	Yes
Commission Sales	Yes	N/A	N/A
Artist Fee	Yes	N/A	N/A
Install/ De-install service	Yes	Negotiation with Curators – fees apply	Negotiation with Curators – fees apply
Catalogue design and print	Yes	No	No
Catering for opening event (not inclusive of alcohol)	Yes	No	No
Invitation designed and distributed via email by the City	Yes	No	No
Advertising	Yes	City limited	City limited

Optional

Selected artists have the option of presenting a community workshop as part of their program. This is in addition to the artist talk or public program requirements as part of the select artist fee. This will be a paid opportunity at NAVA rates and at the discretion of the City and Curators.

